

PART NUMBER	REV	FIRST USED	TERMINATOR	FEED TYPE	DESCRIPTION
1426281-1	L	-	LEADMAKER	MECH POST FEED	CUTS CARRIER
1426281-2	L	-	BENCH	MECH PRE FEED	CUTS CARRIER
1426281-6	L	-	LEADMAKER	MECH POST FEED	CONTINUOUS CARRIER
7-1426281-1	L	-	LEADMAKER	MECH POST FEED	-1 AND SPARE PARTS
7-1426281-2	L	-	BENCH	MECH PRE FEED	-2 AND SPARE PARTS
7-1426281-6	L	-	LEADMAKER	MECH POST FEED	-6 AND SPARE PARTS
7-1426281-7	H	-	LEADMAKER	-	SPARE PARTS KIT FOR -1/-6/7-1/7-6
7-1426281-8	H	-	BENCH	-	SPARE PARTS KIT FOR -2 & 7-2

CRIMP DATA AMP TERMINAL AMP CRIMP SPECS			
TERMINAL NAME: 1.2MM CONTACT ASSEMBLY.			
CRIMP	SIZE	TYPE	RANGE
WIRE	1.57 [.062 IN]	F	20 AWG or 0.50-0.75mm ²
INSUL	1.83 [.072 IN]	SPECIAL	1.40-1.90 [.055-.075 IN] ⁴
WIRE STRIP LENGTH		APPL INSTRUCTION ⁴	
3.00-3.60 [.118-.142 IN]		408-8322	
TERMINAL APPL SPEC	114-18464 ⁵	FEED	7.50 [.295 IN]
TERMINALS APPLIED			
1394897	-	-	-
-	-	-	-
-	-	-	-
-	-	-	-
-	-	-	-
-	-	-	-
-	-	-	-
-	-	-	-
WIRE SIZE mm ² AWG	CRIMP HEIGHT	PIN PN AND LENGTH [IN]	
0.75mm ²	1.09 ±0.03 [.043 ±.001 IN]	1-354779-7 [.3075]	
0.50mm ²	0.98 ±0.03 [.039 ±.001 IN]	2-354779-5 [.3115]	
20 AWG	0.98 ±0.03 [.039 ±.001 IN]	2-354779-5 [.3115]	
-	-	-	
-	-	-	
-	-	-	
-	-	-	
-	-	-	
SET UP GAGE	LAYOUT		
458637-3	L1426281		

- ¹ RECOMMENDED SPARE PARTS.
- 2. GREASE RAM, CAM, CAM FOLLOWER AND FEED ROD LIGHTLY.
- 3. LUBRICATE DAILY PER THE APPLICATOR INSTRUCTION SHEET SUPPLIED WITH THE APPLICATOR.
- ⁴ THIS APPLICATOR HAS BEEN DESIGNED TO APPLY WIRES WITH THIN-WALL (FLR) INSULATION.
- ⁵ MAXIMUM INSULATION CRIMP WIDTH 2.05mm & MAXIMUM INSULATION CRIMP HEIGHT 2.05mm. SEE APPLICATION SPECIFICATION TO CLARIFY.
- ⁶ DUE TO THE DEMANDS OF APPLICATION SPEC 114-18464 IT IS IMPORTANT, IF THE ANVIL IS MOVED OR REPLACED, THAT IT IS BIASED TOWARDS THE OPERATOR'S POSITION AS FAR AS POSSIBLE WHEN RE-SECURING TO THE BASE PLATE.

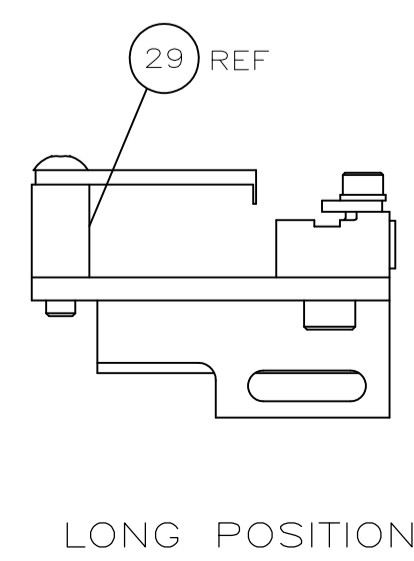
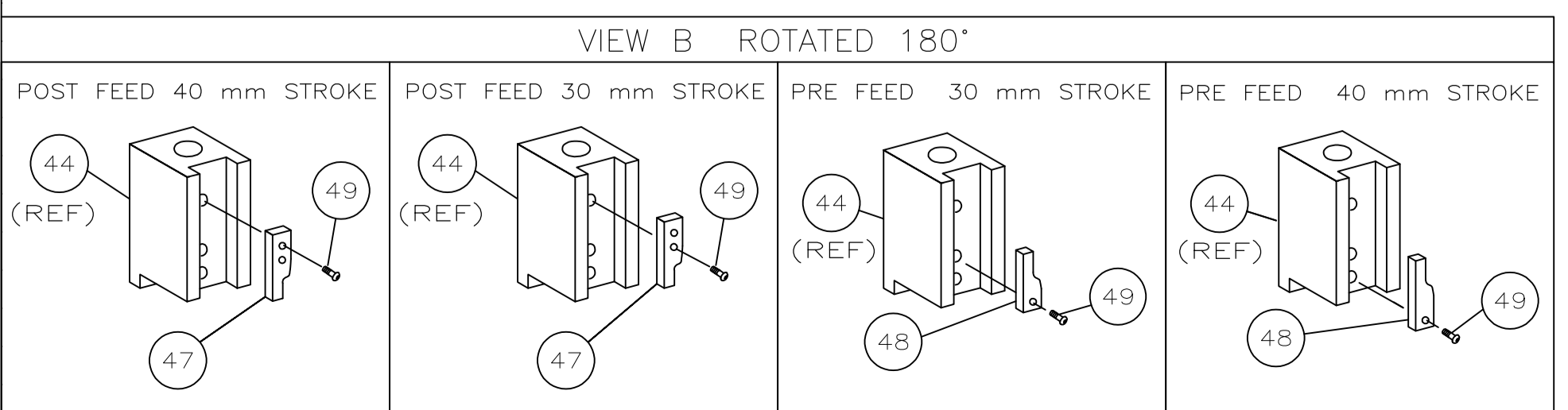
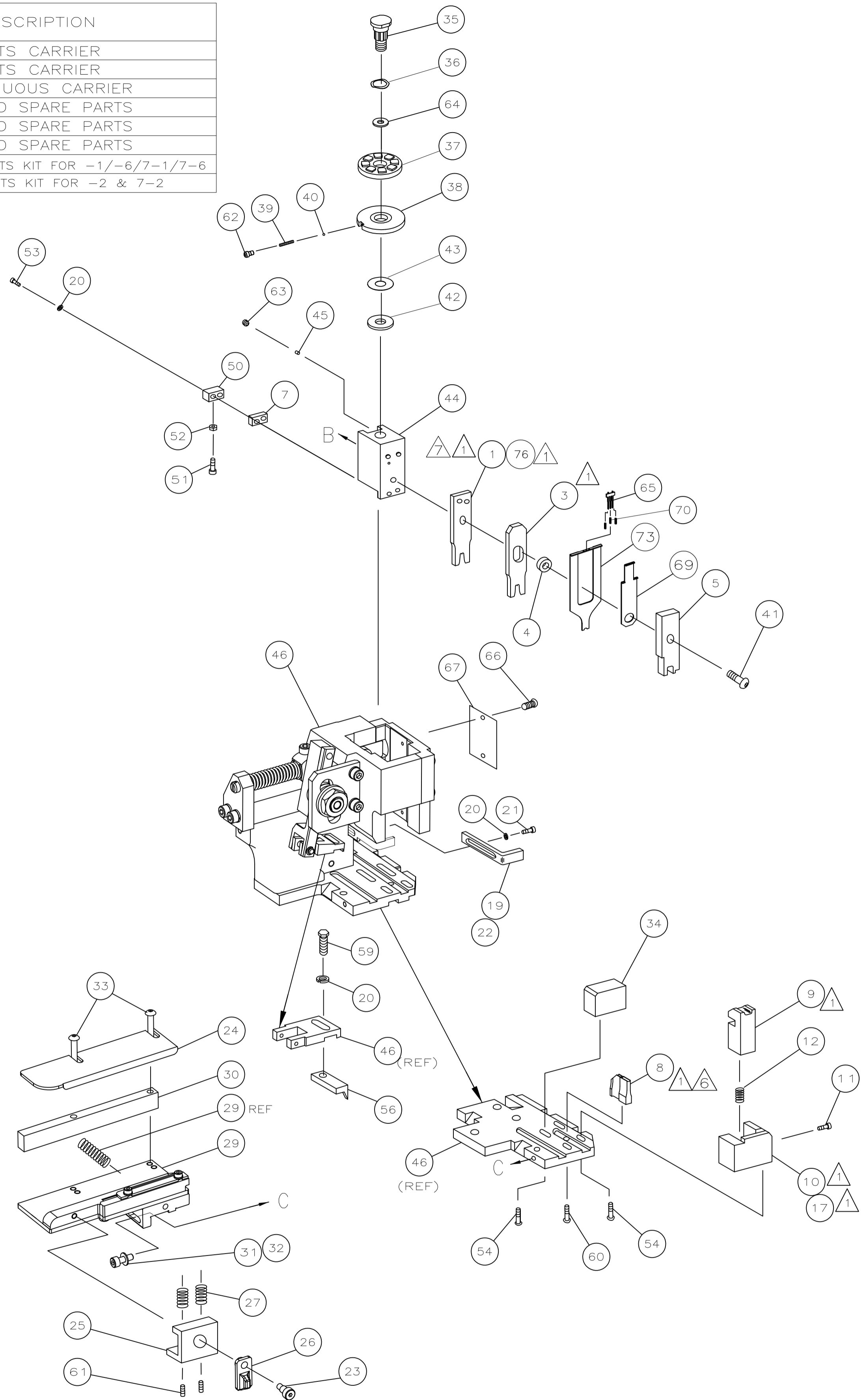

QTY REQD PER ASSY	DESCRIPTION	ITEM NO
1	1-1752057-4	76
-	1490525-6	73
-	1426281	72
-	1338705-1	71
-	2-23147-2	70
-	1490524-1	69
-	461264-1	67
-	21017-2	66
-	1424350-1	65
-	986950-1	64
-	3-18031-0	63
-	18023-9	62
-	2-18032-5	61
-	18024-7	60
-	5-18022-2	59
-	1338685-1	56
-	18024-8	54
-	1-18023-3	53
-	18030-1	52
-	811242-5	51
-	690753-2	50
-	18024-3	49
-	1338675-1	48
-	1338676-1	47
-	1320999-3	46
-	690191-1	45
-	1338660-1	44
-	690125-1	43
-	690124-9	42
-	2-18024-6	41
-	23241-1	40
-	2-22278-7	39
-	1320922-4	38
-	354777-1	37
-	22480-5	36
-	690212-1	35
-	1320934-6	34
-	1-18024-0	33
-	18027-2	32
-	1-18023-2	31
-	1320908-4	30
-	1633073-2	29
-	1-22284-0	28
-	356835-1	27
-	240792-1	26
-	1320928-1	25
-	980371-4	24
-	690472-2	23
-	1-18023-1	22
-	18025-2	21
-	1424364-1	20
-	1338684-1	19
-	3-22280-3	18
-	356885-4	17
-	1320921-1	16
-	1-879745-5	15
-	1333231-2	14
-	5-240641-0	13
-	1-455889-4	12
-	4-238011-2	11
-	1752766-1	10
-	5-456403-0	9
-		8
-		7
-		6
-		5
-		4
-		3
-		2
-		1

THIS DRAWING IS A CONTROLLED DOCUMENT.

TOOLING APPROVED BY GB
 GATD & TERMINAL PRODUCT
 ENGINEERING GERMANY.

LONG POSITION

QTY REQD PER ASSY

PARTS LIST

THIS DRAWING IS A CONTROLLED DOCUMENT.

DIN L10FH0006 07JAN02

CHK -

APVD F BACKHURST 07JAN02

NAME

Tyco Electronics Corporation
 Harrisburg, PA 17105-3608

PRODUCT SPEC

APPLICATION SPEC

SIZE CASE CODE DRAWING NO RESTRICTED TO

WEIGHT A1 00779 C=1426281

CUSTOMER DRAWING SCALE SHEET 1 OF 1 REV

CUSTOMER ACCESSIBLE PRODUCTION DRAWING

Mouser Electronics

Authorized Distributor

Click to View Pricing, Inventory, Delivery & Lifecycle Information:

[TE Connectivity:](#)

[1426281-2](#)