

76829-0006 SHOWN

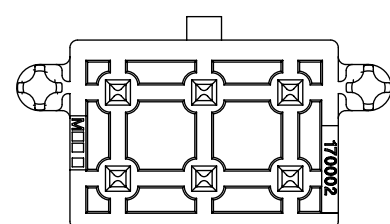

NOTES:

1. MATERIAL:
HOUSING: LCP, UL94V-0, GLOW WIRE CAPABLE PER IEC-60335-1 5TH EDITION,
COLOR: BLACK.
TERMINAL: HIGH CONDUCTIVITY COPPER.
2. TERMINAL PLATING:
(TIN) 1.52 MICROMETER /(60 MICROINCH) MIN REFLOWED MATTE TIN OVER
1.27 MICROMETER /(50 MICROINCH) MIN NICKEL OVERALL.
(15 GOLD) 0.38 MICROMETER /(15 MICROINCH) MIN SELECT GOLD ON CONTACT AREA
2.54 MICROMETER /(100 MICROINCH) MIN SELECT MATTE TIN ON SOLDER AREA
BOTH OVER 1.27 MICROMETER /(50 MICROINCH) MIN NICKEL OVERALL
(30 GOLD) 0.76 MICROMETER /(30 MICROINCH) MIN SELECT GOLD ON CONTACT AREA
2.54 MICROMETER /(100 MICROINCH) MIN SELECT MATTE TIN ON SOLDER AREA
BOTH OVER 1.27 MICROMETER /(50 MICROINCH) MIN NICKEL OVERALL
3. PRODUCT SPECIFICATION PS-76823-100.
4. PART MATES WITH MOLEX PART NUMBER 170001 AND 171692 SERIES.
5. PACKAGING: TRAY PACKED PER MOLEX SPECIFICATION PK-31301-976, WHILE T&R IS 1720650900.
6. APPLICATION SPECIFICATION: AS-76823-100
7. PARTS CONFORM TO CLASS "B" REQUIREMENTS OF COSMETIC SPECIFICATION PS-45499-002.

PENDING APPROVAL

MODEL: 768290000

SYMBOLS	THIS DRAWING CONTAINS INFORMATION THAT IS PROPRIETARY TO MOLEX ELECTRONIC TECHNOLOGIES, LLC AND SHOULD NOT BE USED WITHOUT WRITTEN PERMISSION			
	DIMENSION UNITS	SCALE		CURRENT REV DESC: CORRECT 2CKT PCB
∇ = 0	INCH			EC NO: 605032 DRWN: SCHEN76 2018/09/18 CHK'D: APPR:
∇ = 0	GENERAL TOLERANCES (UNLESS SPECIFIED)			
∇ = 0		MM	INCH	INITIAL REVISION: DRWN: DRWN BY APPR: APPR BY
∇ = 0	4 PLACES	±	±	
∇ = 0	3 PLACES	±	±	XXXX/XX/XX XXXX/XX/XX
∇ = 0	2 PLACES	± 0.25	±	
∇ = 0	1 PLACE	± 0.5	±	SERIES 76829
∇ = 0	0 PLACES	±	±	
∇ = 0	ANGULAR TOL	± 0.5 °		THIRD ANGLE PROJECTION
∇ = 0	DRAFT WHERE APPLICABLE MUST REMAIN WITHIN DIMENSIONS			DRAWING C-SIZE
∇ = 0				SHEET NUMBER 1 OF 3

molex

MEGA-FIT VERTICAL HEADER
VERTICAL HEADER ASSY 2-12 CKT TOP LATCH

PRODUCT CUSTOMER DRAWING

DOCUMENT NUMBER	DOC TYPE	DOC PART	REVISION
SD-76829-0100	PSD	000	D8

MATERIAL NUMBER	CUSTOMER	SHEET NUMBER
	GENERAL MARKET	1 OF 3

DOCUMENT STATUS	RQ	RELEASE DATE	

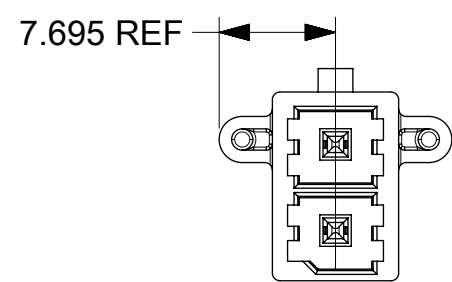

2 CKT

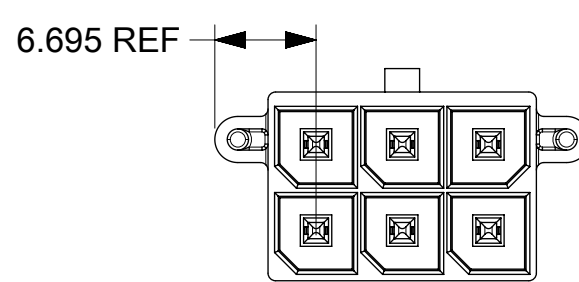

4-12 CKT

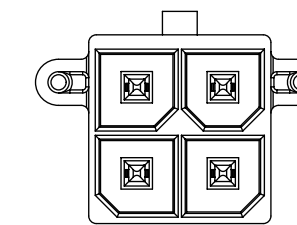

4 CKT

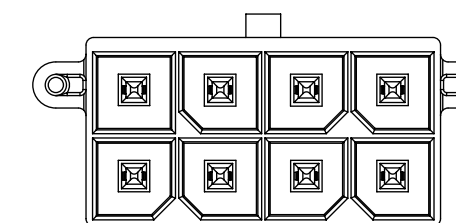

8 CKT

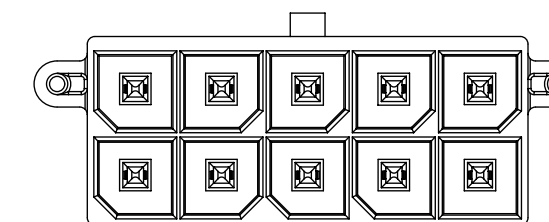

10 CKT

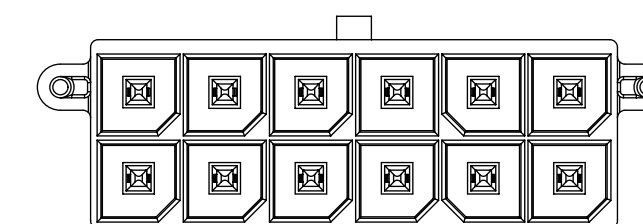

12 CKT

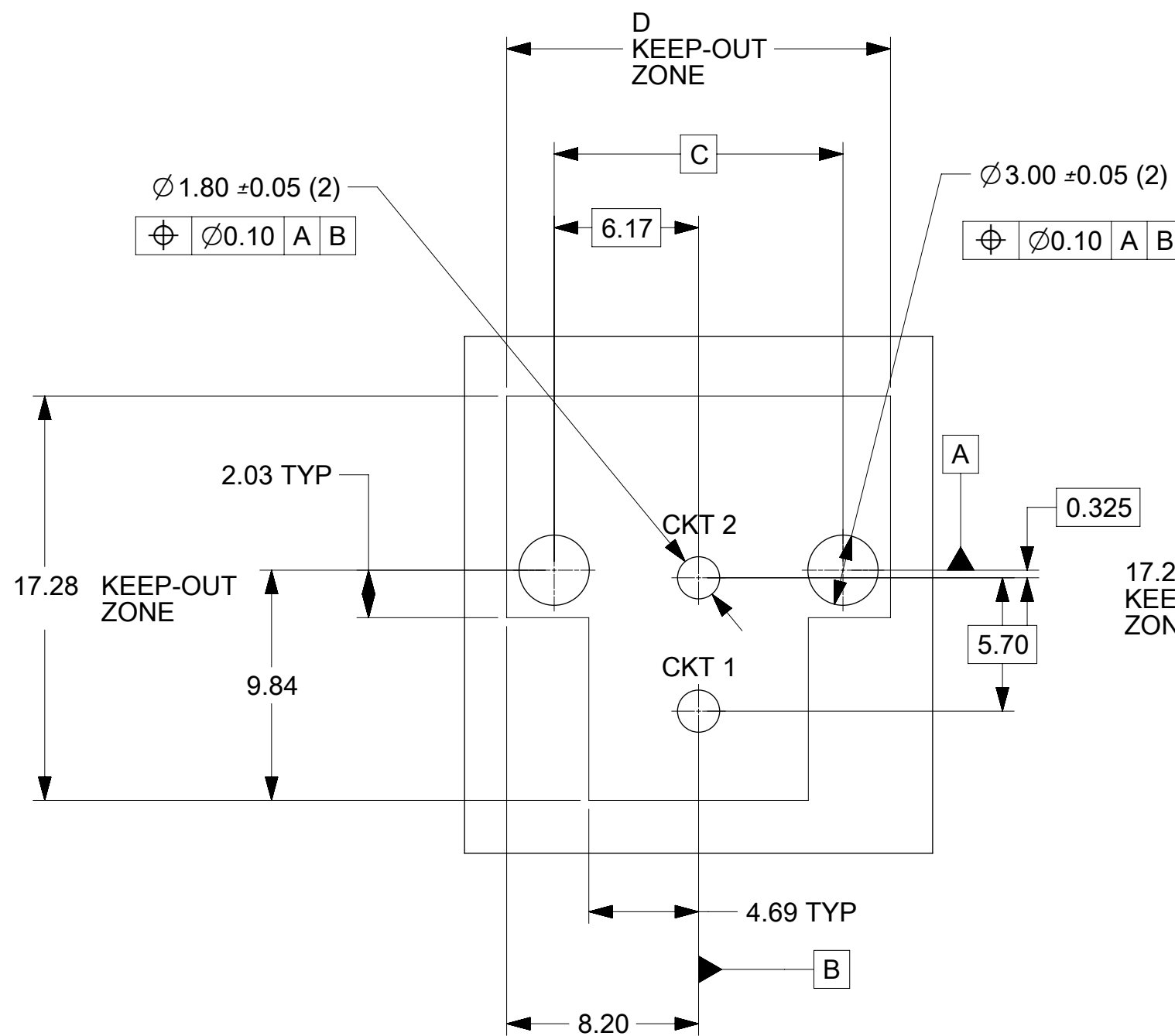

PCB LAYOUT: COMPONENT SIDE
RECOMENDED PCB THICKNESS: 1.58 MM/.062 IN TO
2.36 MM/.093 IN

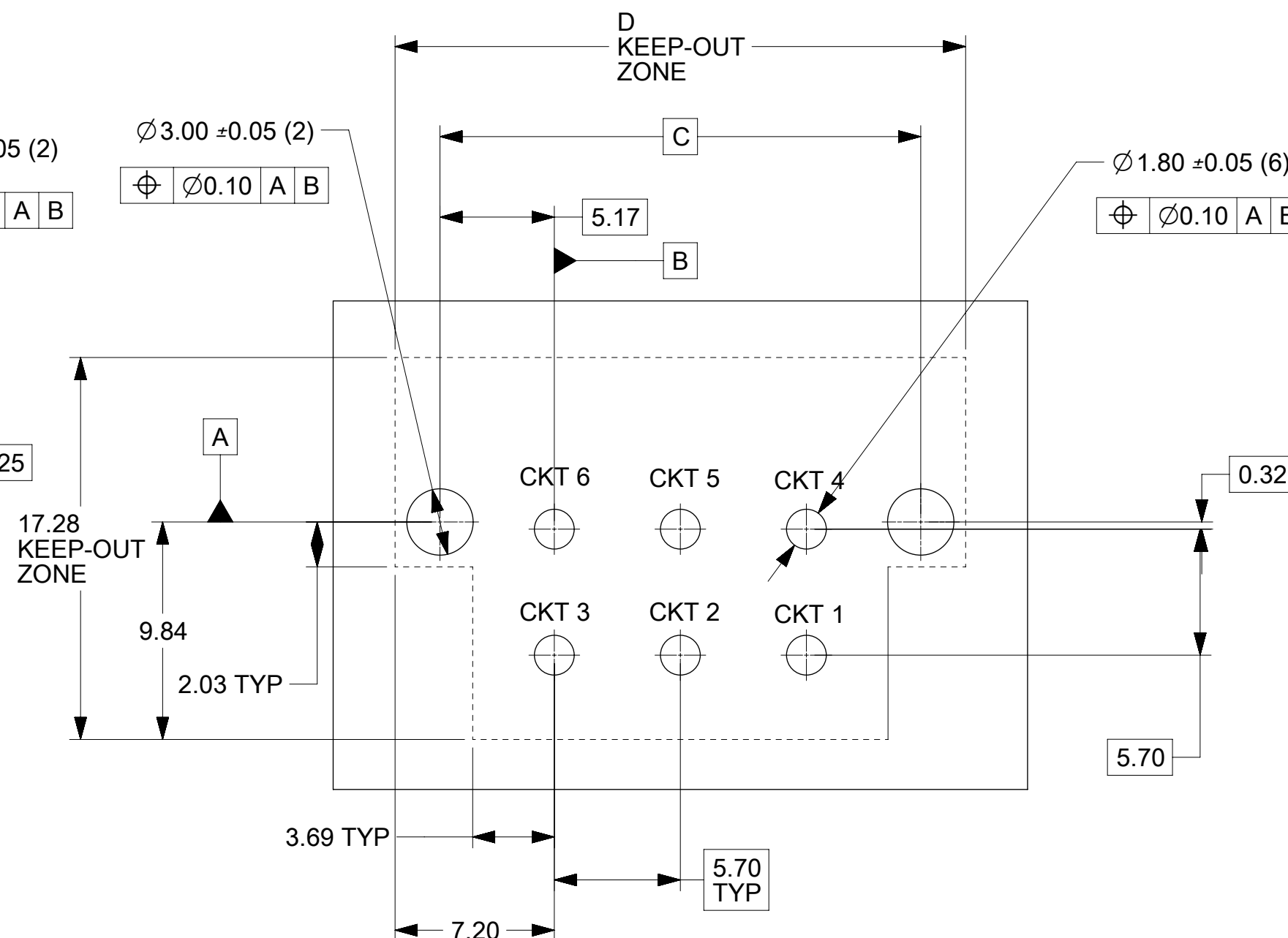

PCB LAYOUT: COMPONENT SIDE
RECOMENDED PCB THICKNESS: 1.58 MM/.062 IN TO
2.36 MM/.093 IN

PENDING APPROVAL

THIS DRAWING CONTAINS INFORMATION THAT IS PROPRIETARY TO MOLEX ELECTRONIC TECHNOLOGIES, LLC AND SHOULD NOT BE USED WITHOUT WRITTEN PERMISSION											
SYMBOLS		DIMENSION UNITS		SCALE		CURRENT REV DESC: CORRECT 2CKT PCB					
= 0		INCH				EC NO: 605032					
= 0		GENERAL TOLERANCES (UNLESS SPECIFIED)				DRWN: SCHEN76 2018/09/18					
= 0						CHK'D:					
= 0		4 PLACES ±		MM INCH		APPR:					
= 0		3 PLACES ±				INITIAL REVISION:					
= 0		2 PLACES ± 0.25				DRWN: DRWN BY XXXX/XX/XX					
= 0		1 PLACE ± 0.5				APPR: APPR BY XXXX/XX/XX					
= 0		0 PLACES ±				DRAFT WHERE APPLICABLE MUST REMAIN WITHIN DIMENSIONS		THIRD ANGLE PROJECTION		DRAWING SERIES	
= 0						C-SIZE		76829		MATERIAL NUMBER	
= 0										CUSTOMER	
										GENERAL MARKET	
										SHEET NUMBER	
										2 OF 3	

molex

MEGA-FIT VERTICAL HEADER
VERTICAL HEADER ASSY 2-12 CKT TOP LATCH

PRODUCT CUSTOMER DRAWING

DOCUMENT NUMBER	DOC TYPE	DOC PART	REVISION
SD-76829-0100	PSD	000	D8

DOCUMENT STATUS	RQ	RELEASE DATE	
12	11	10	9

12	11	10	9	8	7	6	5	4	3	2	1	
CKT SIZE	PART NO.	PLATING	DIM A	DIM B	DIM C BASIC	DIM D	PK SPEC					
2	76829-0002	TIN	8.35	15.39	12.34	16.40	TRAY					
4	76829-0004	TIN	12.05	19.09	16.04	20.10						
6	76829-0006	TIN	17.75	24.79	21.74	25.80						
8	76829-0008	TIN	23.45	30.49	27.44	31.50						
10	76829-0010	TIN	29.15	36.19	33.14	37.20						
12	76829-0012	TIN	34.85	41.89	38.84	42.90						
2	172065-0002	15 GOLD	8.35	15.38	12.34	16.40						
4	172065-0004	15 GOLD	12.05	19.09	16.04	20.10						
6	172065-0006	15 GOLD	17.75	24.79	21.74	25.80						
8	172065-0008	15 GOLD	23.45	30.49	27.44	31.50						
10	172065-0010	15 GOLD	29.15	36.19	33.14	37.20						
12	172065-0012	15 GOLD	34.85	41.89	38.84	42.90						
2	172065-1002	30 GOLD	8.35	15.38	12.34	16.40						
4	172065-1004	30 GOLD	12.05	19.09	16.04	20.10						
6	172065-1006	30 GOLD	17.75	24.79	21.74	25.80						
8	172065-1008	30 GOLD	23.45	30.49	27.44	31.50						
10	172065-1010	30 GOLD	29.15	36.19	33.14	37.20						
12	172065-1012	30 GOLD	34.85	41.89	38.84	42.90						

12	11	10	9	8	7	6	5	4	3	2	1	
CKT SIZE	PART NO.	PLATING	DIM A	DIM B	DIM C BASIC	DIM D	PK SPEC					
*	2	76829-0902	TIN	8.35	15.38	12.34	16.40	TAPE&REEL WITHOUT KAPTON				
	4	76829-0904	TIN	12.05	19.09	16.04	20.10					
	6	76829-0906	TIN	17.75	24.79	21.74	25.80					
	8	76829-0908	TIN	23.45	30.49	27.44	31.50					
*	10	76829-0910	TIN	29.15	36.19	33.14	37.20					
*	12	76829-0912	TIN	34.85	41.89	38.84	42.90					
*	2	172065-0902	15 GOLD	8.35	15.38	12.34	16.40					
	4	172065-0904	15 GOLD	12.05	19.09	16.04	20.10					
	6	172065-0906	15 GOLD	17.75	24.79	21.74	25.80					
	8	172065-0908	15 GOLD	23.45	30.49	27.44	31.50					
*	10	172065-0910	15 GOLD	29.15	36.19	33.14	37.20					
*	12	172065-0912	15 GOLD	34.85	41.89	38.84	42.90					
*	2	172065-1902	30 GOLD	8.35	15.38	12.34	16.40					
	4	172065-1904	30 GOLD	12.05	19.09	16.04	20.10					
	6	172065-1906	30 GOLD	17.75	24.79	21.74	25.80					
	8	172065-1908	30 GOLD	23.45	30.49	27.44	31.50					
*	10	172065-1910	30 GOLD	29.15	36.19	33.14	37.20					
*	12	172065-1912	30 GOLD	34.85	41.89	38.84	42.90					
*	2	76829-0702	TIN	8.35	15.38	12.34	16.40		TAPE&REEL WITH KAPTON			
*	4	76829-0704	TIN	12.05	19.09	16.04	20.10					
*	6	76829-0706	TIN	17.75	24.79	21.74	25.80					
*	8	76829-0708	TIN	23.45	30.49	27.44	31.50					
*	10	76829-0710	TIN	29.15	36.19	33.14	37.20					
*	12	76829-0712	TIN	34.85	41.89	38.84	42.90					
*	2	172065-0702	15 GOLD	8.35	15.38	12.34	16.40					
*	4	172065-0704	15 GOLD	12.05	19.09	16.04	20.10					
*	6	172065-0706	15 GOLD	17.75	24.79	21.74	25.80					
*	8	172065-0708	15 GOLD	23.45	30.49	27.44	31.50					
*	10	172065-0710	15 GOLD	29.15	36.19	33.14	37.20					
*	12	172065-0712	15 GOLD	34.85	41.89	38.84	42.90					
*	2	172065-1702	30 GOLD	8.35	15.38	12.34	16.40					
*	4	172065-1704	30 GOLD	12.05	19.09	16.04	20.10					
*	6	172065-1706	30 GOLD	17.75	24.79	21.74	25.80					
*	8	172065-1708	30 GOLD	23.45	30.49	27.44	31.50					
*	10	172065-1710	30 GOLD	29.15	36.19	33.14	37.20					
*	12	172065-1712	30 GOLD	34.85	41.89	38.84	42.90					

* DESIGNATES PART NOT RELEASED
CONTACT FACTORY FOR AVAILABILITY.

PENDING APPROVAL

THIS DRAWING CONTAINS INFORMATION THAT IS PROPRIETARY TO MOLEX ELECTRONIC TECHNOLOGIES, LLC AND SHOULD NOT BE USED WITHOUT WRITTEN PERMISSION																
SYMBOLS		DIMENSION UNITS		SCALE		CURRENT REV DESC: CORRECT 2CKT PCB										
∅ = 0	INCH					molex MEGA-FIT VERTICAL HEADER VERTICAL HEADER ASSY 2-12 CKT TOP LATCH PRODUCT CUSTOMER DRAWING DOCUMENT NUMBER: SD-76829-0100 DOC TYPE: PSD DOC PART: 000 REVISION: D8 MATERIAL NUMBER: CUSTOMER: GENERAL MARKET SHEET NUMBER: 3 OF 3										
∇ = 0	GENERAL TOLERANCES (UNLESS SPECIFIED)				EC NO: 605032							DRWN: SCHEN76		2018/09/18		
∇ = 0					CHK'D:							APPR:				
∇ = 0					INITIAL REVISION:							DRWN: DRWN BY		XXXX/XX/XX		
∇ = 0					APP: APPR BY		XXXX/XX/XX									
∇ = 0	ANGULAR TOL ± 0.5 °		THIRD ANGLE PROJECTION		DRAWING		SERIES		76829							
∇ = 0	DRAFT WHERE APPLICABLE MUST REMAIN WITHIN DIMENSIONS		C-SIZE		76829											

MODEL: 768290000

DOCUMENT STATUS	RQ	RELEASE DATE									
12	11	10	9	8	7	6	5	4	3	2	1