

PART NUMBER	REV	FIRST USED
1385829-1	A	122500-1
1385829-2	A	565435-5
1385829-3	A	354500-1

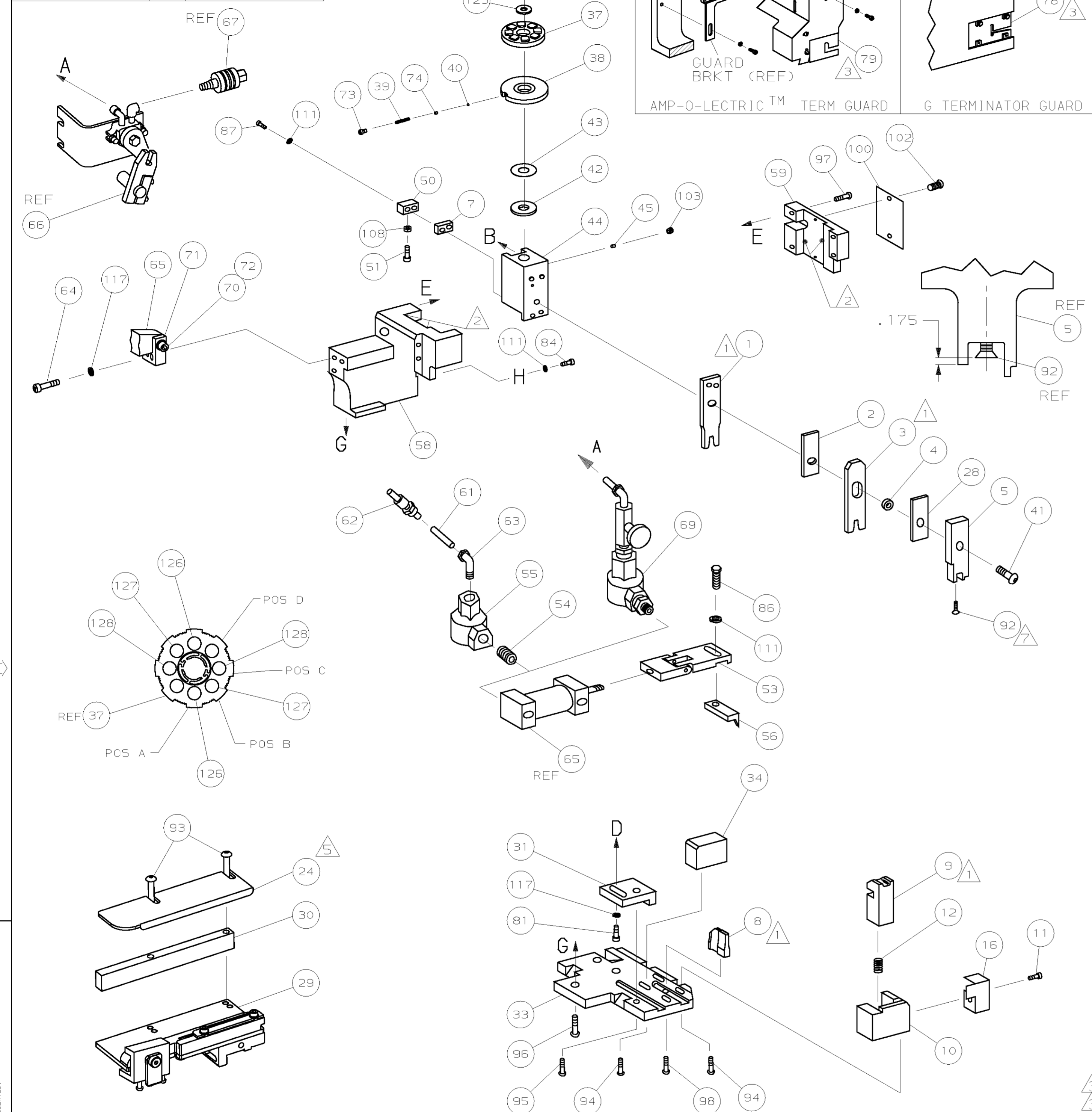

- 1 RECOMMENDED SPARE PARTS.
- 2 GREASE LIGHTLY.
- 3 GUARD MUST BE IN PLACE WHEN OPERATING APPLICATOR IN A BENCH MACHINE.
- 4 SEE DRAWING FOR COMPONENTS
- 5 REAR STRIP GUIDE TO GUIDE ON INSULATION BARREL.
- 6 THIS APPLICATOR APPLIES TERMINAL WITH A SEAL.
- 7 APPLY TORQ-SEAL IN ALLEN SOCKET TO FILL HOLE AFTER FLAT HD HAS BEEN ADJUSTED TO CORRECT HEIGHT AT QUALIFICATION. APPLY PN 1-23419-5 LOC-TITE TO THREADS.
- 8 ADJUST FEED BETWEEN PIN AND SOCKET.

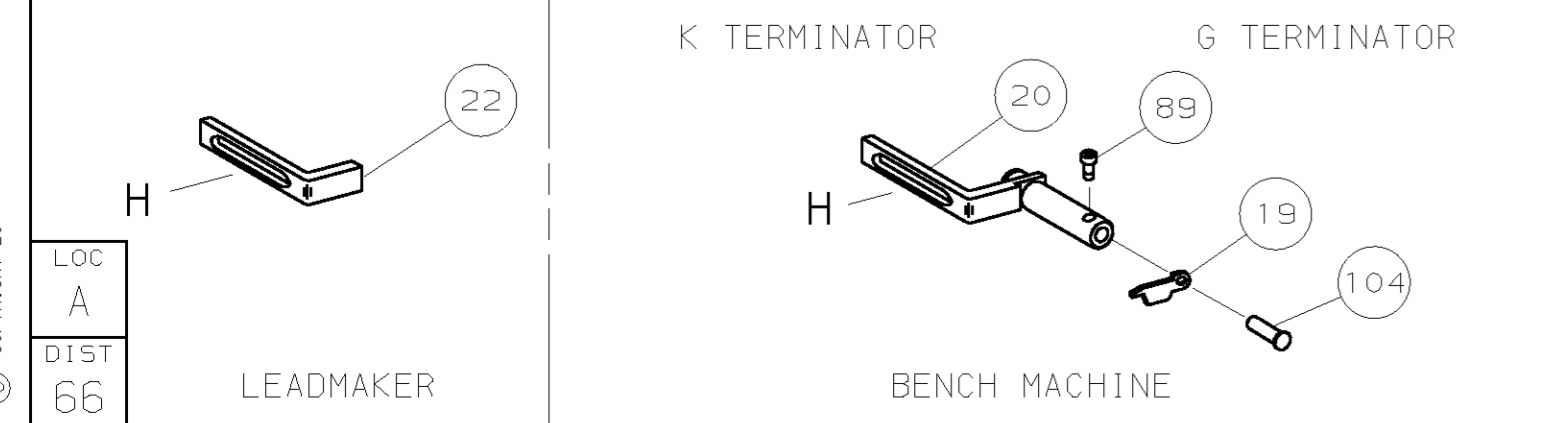

AMP SEAL PN		MFR SEAL PN		WIRE STRIP LENGTH		TERM APPL	SPEC	FEED	APPL INSTRUCTION	SET UP GAGE	LAYOUT
1572594	7116-4140-02	1572595	7114-4140-02	.240-	.257	NONE			408-8040	458637-1	L3044

QTY	RECD	PER	ASSY	U/M	DWG SIZE	PART NO	DESCRIPTION	ITEM NO
2	2	2	-	C		4-354779-2	PIN, WIRE DISC (.3200)C	129
2	2	2	-	C		3-354779-8	PIN, WIRE DISC (.3180)B	127
2	2	2	-	C		3-354779-6	PIN, WIRE DISC (.3170)A	126
1	1	1	-	A		986950-1	WASHER, FLAT PRECISION	125
1	1	1	-	A		217238-1	GENERAL INSTRUCTION PACKAGE	124
1	1	1	-	-		4088040	SF APPL INST 408-8040	123
								122
								121
								120
								119
								118
3	3	3	-	A		21024-5	WASHER, LOCK (#10)ADJ BLOCK	117
								116
								115
								114
								113
								112
4	4	4	-	A		21024-4	WASHER, LOCK (#8) STRIPPER	111
								110
								109
1	1	1	-	A		21018-5	NUT, HEX (NO. 6) HOLDDOWN	108
								107
								106
								105
1	1	-	-	A		992031-1	PIN, CLEVIS	104
1	1	1	-	A		21009-2	SCR, SKT 5ET(1/4-20x.25 LW)RAM	103
2	2	2	-	A		21017-2	SCR, DRIVE (#2x.19) ID PLATE	102
								101
1	1	1	-	B		461264-1	PLATE, IDENTIFICATION	100
								99
1	1	1	-	A		22733-8	SCR, BHC (8-32x.38 LW) ANVIL	98
4	4	4	-	A		2-21002-9	SCR, BHC (10-32x.75) CAP	97
3	3	3	-	A		2-22733-8	SCR, BHC (1/4-20x.62) H5G	96
1	1	1	-	A		2-21002-7	SCR, BHC (10-32x.50) 5G ADJ BLK	95
4	4	4	-	A		2-21002-2	SCR, BHC (8-32x.50) TERM H DWN	94
2	2	2	-	A		2-21002-4	SCR, BHC (8-32x.75) R STP GDE	93
1	1	1	-	A		1-21003-9	SCR, FHC (6-32x.38) DEP	92
								91
								90
1	1	-	-	A		7-21000-9	SCR, SHC (4-40x.19) STRIPPER	89
								88
2	2	2	-	A		2-21000-7	SCR, SHC (8-32x.50) DEP-HOLD	87
1	1	1	-	A		2-22603-1	SCR, HEX HD (8-32x.38) FEED FINGER	86
								85
1	1	1	-	A		2-21000-7	SCR, SHC (8-32x.50) STRIPPER	84
								83
								82
1	1	1	-	A		3-21000-4	SCR, SHC (10-32x.38) 5G ADJ BL	81
								80
-	1	-	-	B		462992-7	GUARD ASSY	79
REF	-	-	-	B		679532-1	INSERT, GUARD	78
								77
								76
								75
1	1	1	-	A		690603-1	SPRING, ASSIST	74
1	1	1	-	A		23030-1	SCR, SHC (6-32x.25 SL) INS DISC	73
1	1	1	-	A		3-21001-5	SCR, SHC (3/8-16x1.00) AIR FEED	72
1	1	1	-	B		459610-1	MOUNT, FEED BRACKET	71
								70
								69
								68
								67
								66
								65
								64
								63
								62
								61
								60
								59
								58
								57
								56
								55
								54
								53
								52
								51
								50
								49
								48
								47
								46
								45
								44
								43
								42
								41
								40
								39
								38
								37
								36
								35
								34
								33
								32
								31
								30
								29
								28
								27
								26
								25
								24
								23
								22
								21
								20
								19
								18
								17
								16
								15
								14
								13
								12
								11
								10
								9
								8
								7
								6
								5
								4
								3
								2
								1

QTY	RECD	PER	ASSY	U/M	DWG SIZE	PART NO	DESCRIPTION	ITEM NO
-1						LEADMAKER	AIRFEED	
-2						BENCH MODEL K	AIRFEED	
-3						BENCH MODEL G	AIRFEED	
1	1	1	-	A		21024-8	WASHER, LOCK 3/8	70
-	1	-	-	C		692655-5	AIR FEED VALVE ASSY	69
								68
-	REF	-	-	A		24042-2	VALVE, SHUT OFF	67
-	REF	-	-	C		692655-6	AIR FEED VALVE ASSY	66
1	1	1	-	B		461065-1	AIR FEED ASSY (1 INCH)	65
2	2	2	-	A		3-21000-9	SCR, SHC (10-32x1.00) AIR ASSY	64
1	-	1	-	A		980285-2	ELBOW, SWIVEL 1/8 NPT - 1/4 T	63
1	-	1	-	A		23238-1	QUICK DISCONNECT	62
21.00	-	21.00	IN	A		27319-4	TUBING, POLY-FLO Ø.25	61
								60
1	1	1	-	C		454220-1	CAP, RAM	59
1	1	1	-	D		454485-1	HOUSING	58
								57
								56
1	1	1	-	B		2-694433-6	PAWL, FEED	55
1	-	1	-	A		22374-7	VALVE, QUICK EXHAUST	54
1	-	1	-	A		22304-1	NIPPLE, HEX	53
1	1	1	-	B		461062-1	FEED FINGER ASSY	52
								51
1	1	1	-	A		811242-2	BUMPER, HOLDDOWN	50
1	1	1	-	A		690753-1	SPACER, TONKER	49
								48
								47
								46
								45
1	1	1	-	A		690191-1	PLUG, NYLON	44
1	1	1	-	C		819307-9	RAM	43
1	1	1	-	A		690125-1	WASHER, LAMINATED	42
1	1	1	-	A		690124-1	WASHER, RAM	41
1	1	1	-	A		7-21002-9	BOLT, CRIMPER (5/16x1.00)	40
1	1	1	-	A		23241-6	BALL, STEEL	39
1	1	1	-	A		690170-1	SPRING, COMPRESSION	38
1	1	1	-	C		1-690142-0	DISC, INSULATION	37
1	1	1	-	D		354777-1	DISC, WIRE	36
1	1	1	-	A		22480-5	WASHER, SPRING	35
1	1	1	-	B		690212-1	POST, RAM	34
1	1	1	-	B		690786-1	SUPPORT, TERMINAL	33
1	1	1	-	D		318055-4	PLATE, BASE	32
								31
1	1	1	-	B		455689-1	BLOCK, ADJ. STRIP GUIDE	30
1	1	1	-	B		1320908-2	SPACER, STRIP GUIDE	29
1	1	1	-	C		1633091-7	STRIP GUIDE ASSEMBLY	28
1	1	1	-	C		455888-8	SPACER, FRONT SHEAR DEP	27
								26
								25
								24
1	1	1	-	D		1320928-3	GUIDE, STRIP (REAR)	23
								22
-	-	1	-	B		690472-2	STRIPPER	21
								20
1	1	-	-	A		679218-1	STRIPPER WIRE STOP ASSY	19
1	1	-	-	B		458949-1	STRIPPER	18
								17
								16
1	1	1	-	B		318563-1	GUARD, CHIP, FRONT	15
								14
								13
1	1	1	-	A		4-22280-8	SPRING, SHEAR	12
1	1	1	-	B		1-21000-9	SCR, SHC (8-32x.38) SHEAR STOP	11
1	1	1	-	C		2-690459-2	HOLDER, SHEAR (FRONT)	10
1	1	1	-	C		318059-4	SHEAR, FLOAT (FRONT)	9
1	1	1	-	C		3-662188-9	ANVIL	8
1	1	1	-	C		4-240641-2	SPACER, DEPRESSOR (REAR)	7
								6
								5
								4
								3
								2
								1

QTY	RE
-----	----

# Mouser Electronics

Authorized Distributor

Click to View Pricing, Inventory, Delivery & Lifecycle Information:

[TE Connectivity:](#)

[1385829-3](#)