

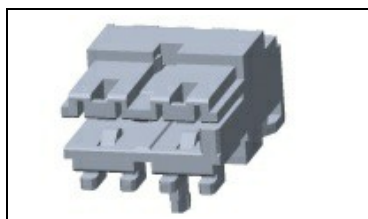

1-1740533-4 Product Details

[Share](#) [Print](#) [Email](#)

1-1740533-4

TE Internal Number: 1-1740533-4
✔ Active

[View 3D PDF](#)

2.5mm & 5mm Centerline Connector System (AMP DUOPLUG)

✔ Always EU RoHS/ELV Compliant (Statement of Compliance)

Product Highlights:

- Connector
- 5.00 mm Centerline
- Connector Assembly
- Connector Style = Receptacle
- Contact Type = Socket

[View all Features](#)

Quick Links

- ▶ [Pricing & Availability](#)
- ▶ [Search for Tooling](#)
- ▶ [Product Feature Selector](#)
- ▶ [Contact Us About This Product](#)

[Add to My Part List](#) [Request Sample](#) [Find Similar Products](#) [Buy Product](#)

Documentation & Additional Information

Product Drawings:

- [AMP DUOPLUG POWER FEMALE CONNECTOR 2-9 POSITION \(WIT... \(PDF, English\)](#)

Catalog Pages/Data Sheets:

- None Available

Product Specifications:

- None Available

Application Specifications:

- None Available

Instruction Sheets:

- None Available

CAD Files: (CAD Format & Compression Information)

- [2D Drawing \(DXF, Version B\)](#)
- [3D Model \(IGES, Version B\)](#)
- [3D Model \(STEP, Version B\)](#)

[List all Documents](#)

Additional Information:

- [Product Line Information](#)

Related Products:

- [Tooling](#)

[Feedback](#)

Product Features (Please use the Product Drawing for all design activity)

Product Type Features:

- Product Type = Connector
- Connector Type = Connector Assembly
- Wire/Cable Type = Stranded
- Wire Size (mm² [AWG]) = 0.35-0.75² [22-18]
- Wire Insulation Diameter (mm [in]) = 2.20 [0.087]
- Color = Blue

Termination Features:

- Termination Method to Wire/Cable = Insulation Displacement Crimp (IDC)

Body Features:

- Selectively Loaded = No
- Keying Between Cavity Number(s) = 2/3

Contact Features:

- Contact Type = Socket
- Contact Base Material = Copper Tin
- Contact Plating, Mating Area, Material = Tin

Housing Features:

- Centerline (mm [in]) = 5.00 [0.197]
- Connector Style = Receptacle
- Housing Material = PA6 GF

Configuration Features:

- [Number of Positions](#) = 4

Industry Standards:

- [RoHS/ELV Compliance](#) = RoHS compliant, ELV compliant
- [Lead Free Solder Processes](#) = Not relevant for lead free process
- RoHS/ELV Compliance History = Always was RoHS compliant
- UL Flammability Rating = UL 94V-0

Conditions for Usage:

- [Applies To](#) = Wire/Cable
- For Use With = PCB Frame

Operation/Application:

- Industry Application = Appliances

Packaging Features:

- Packaging Quantity = 1,848

Other:

- Brand = TE Connectivity

Corporate Information

[About TE](#)
[Investors](#)
[News Room](#)
[Supplier Portal](#)
[Careers](#)
[Terms & Conditions](#)
[Privacy Policy](#)
[AODA Accessibility Policy](#)
[AODA Multi-Year Accessibility Plan](#)

Quick Links

[Distributor Inventory](#)
[Product Cross Reference](#)
[Documents & Drawings](#)
[Product Compliance Support Center](#)
[Site Map](#)

Customer Support

[Email or Chat With Us](#)
[Find a Phone Number](#)
[Knowledge Base](#)
[Manage Your Account](#)

Keep Me Informed

