

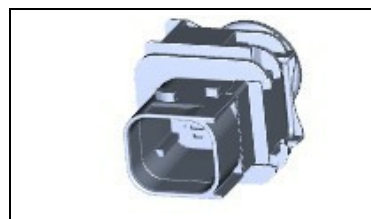

# 1-1703818-1 Product Details



**1-1703818-1**

TE Internal Number: 1-1703818-1

Active

View 3D PDF

## Multiple Contact Point (MCP) & MCON Contact Systems

Always EU RoHS/ELV Compliant (Statement of Compliance)

### Product Highlights:

- HDSCS Product Line, Multiple Contact Point (MCP) Product Line
- Wire-to-Wire
- Applies To Wire/Cable
- Connector
- Housing

[View all Features](#)

### Quick Links

- ▶ [Pricing & Availability](#)
- ▶ [Search for Tooling](#)
- ▶ [Product Feature Selector](#)
- ▶ [Contact Us About This Product](#)

[Add to My Part List](#) | [Request Sample](#) | [Find Similar Products](#) | [Buy Product](#)

## Documentation & Additional Information

### Product Drawings:

- [4POS, TAB 2.8x0.8, TAB HSG, ASSY 4pos, TAB 2.8x0.8, ... \(PDF, English\)](#)

### Catalog Pages/Data Sheets:

- None Available

### Product Specifications:

- [Heavy Duty Sealed Connector Series 2 to 18 positions... \(PDF, German\)](#)

### Application Specifications:

- [Heavy Duty Sealed Connector Series \(HDSCS\) 2 to 18 p... \(PDF, English\)](#)

### Instruction Sheets:

- None Available

### CAD Files: (CAD Format & Compression Information)

- [2D Drawing \(DXF, Version H\)](#)
- [3D Model \(IGES, Version H\)](#)
- [3D Model \(STEP, Version H\)](#)

### Related Products:

- [Tooling](#)

[List all Documents](#)

## Product Features (Please use the Product Drawing for all design activity)

### Product Type Features:

- Product Line = HDSCS, Multiple Contact Point (MCP)
- Product Type = Connector
- Connector Type = Housing
- [Wire/Cable Type](#) = FLR (Thin Walled Cable)
- Key Type = Standard
- Sealed = Yes

### Mechanical Attachment:

- Contact Retention = With
- Contact Retention Type = Secondary Locking/Retainer
- Mating Retention Type = Latching

### Electrical Characteristics:

- Operating Voltage (VDC) = 42
- Operating Voltage Reference = DC

### Termination Features:

- Termination Method to Wire/Cable = Crimp
- Seal Type = Peripheral

### Dimensions:

- Mating Area Interface Dimensions (mm [in]) = 2.79 [.110]

### Body Features:

- Cable Exit Angle = 180°
- Mating Retention = With
- Wire Type = Stranded

### Housing Features:

- Connector Style = Plug
- Housing Material = PBT - GF30
- Housing Color = Black
- Mating Alignment = With
- Mating Alignment Type = Keyed

### Configuration Features:

- Number of Positions = 4
- Number of Rows = 2

### Industry Standards:

- [RoHS/ELV Compliance](#) = RoHS compliant, ELV compliant
- [Lead Free Solder Processes](#) = Not relevant for lead free process
- RoHS/ELV Compliance History = Always was RoHS compliant
- UL Flammability Rating = UL 94V-0

### Identification Marking:

- Keying = A

### Environmental:

- Operating Temperature (°C [°F]) = -40 - +140 [-40 - +284]

### Conditions for Usage:

- Applies To = Wire/Cable

### Operation/Application:

- Application Use = Wire-to-Wire

- Seal Material = Silicone MVQ
- Seal Color = White
- Used With = Receptacle Housing

**Contact Features:**

- Contact Type = Tab

**Packaging Features:**

- Packaging Method = Box/Carton
- Packaging Quantity = 380

**Other:**

- Brand = TE Connectivity
- Comment = IP67 and IP69K

**Corporate Information**

- About TE
- Investors
- News Room
- Supplier Portal
- Careers
- Terms & Conditions
- Privacy Policy
- AODA Accessibility Policy
- AODA Multi-Year Accessibility Plan

**Quick Links**

- Distributor Inventory
- Product Cross Reference
- Documents & Drawings
- Product Compliance Support Center
- Site Map

**Customer Support**

- Email or Chat With Us
- Find a Phone Number
- Knowledge Base
- Manage Your Account

**Keep Me Informed**

