

THIS DRAWING IS UNPUBLISHED. RELEASED FOR PUBLICATION MAY, 2008  
 COPYRIGHT 2008 BY TYCO ELECTRONICS CORPORATION. ALL RIGHTS RESERVED.

LOC	DIST	REVISIONS			
P	LTR	DESCRIPTION	DATE	DMN	APVD
	A	RELEASED	13MAY2008	T.S	A.O

- 1 : AS SHOWN

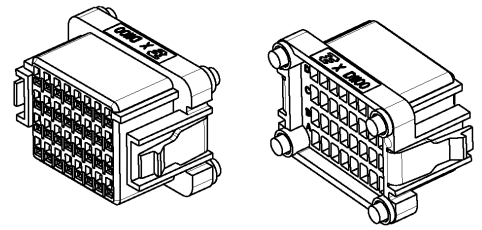
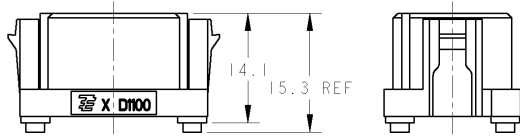
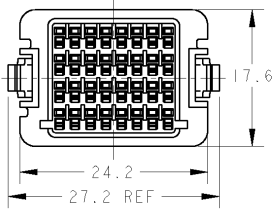

NOTE

- 1. MATERIAL:  
 HOUSING: POLYBUTYLEN TEREPHTHALATE (94V-0)  
 COLOR: BLACK  
 RUBBER: NITRILE-BUTADIENE RUBBER  
 COLOR: BLACK
- 2. THE SHAPE, SIZE AND POSITION OF THE CHARACTER SHOW THE OUTLINE. THEY DON'T SHOW DETAILS.

注記

- 1. 材料:  
 ハウジング: ポリアチレンテレフタレート (94V-0)  
 色: 黒  
 ゴム: ニトリルブタジエンゴム  
 色: 黒
- 2. 文字の形状、大きさ、および位置については、大略を示すものであり、詳細を示すものではありません。

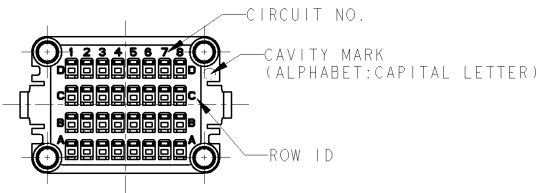

<small>THIS DRAWING IS A CONTROLLED DOCUMENT FOR TYCO ELECTRONICS CORPORATION. IT IS SUBJECT TO CHANGE AND THE CONTROLLING ENGINEERING ORGANIZATION SHOULD BE CONTACTED FOR THE LATEST REVISION.</small>		DWN 22OCT2007 T. SAMI CHK A. OISHI 13MAY2008 APVD A. OISHI 13MAY2008	Tyco Electronics Corporation Kawasaki, Japan
DIMENSIONS: mm 	TOLERANCES UNLESS OTHERWISE SPECIFIED: ± 0.3 0-PLC ± 1-PLC ± 2-PLC ± 3-PLC ± 4-PLC ± ANGLES ± 0.5° FINISH -	NAME MULTIPLE ENCLOSURE CONN. MOLD TYPE REC HSG. 32POS PRODUCT SPEC 108-78417 APPLICATION SPEC 411-78293 WEIGHT 3.5 g	SIZE CAGE CODE DRAWING NO A3 00779 C-1981921 RESTRICTED TO -
MATERIAL		CUSTOMER DRAWING SCALE 2:1 SHEET 1 OF 1 REV A	

AMP 1470-19 REV 31MAR2000

Proj:ENGINEER DRAWING