

RECOMMENDED HOLE PATTERN)

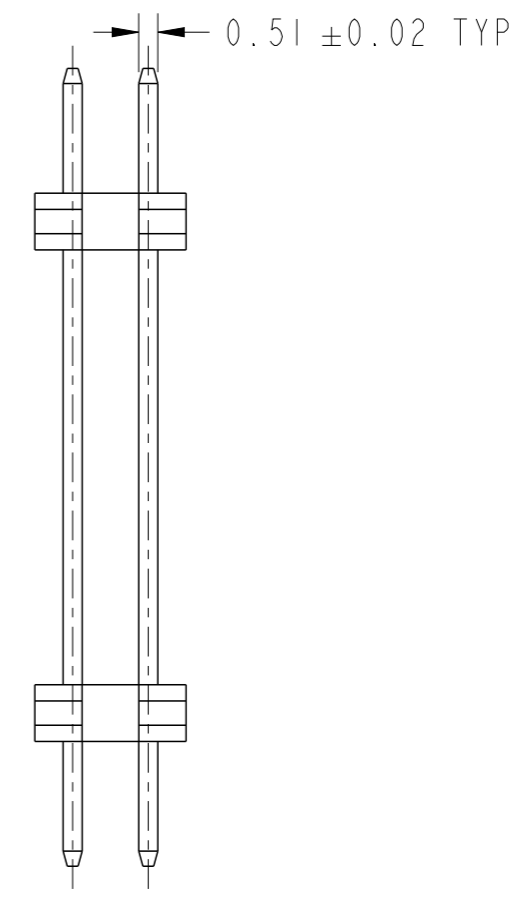
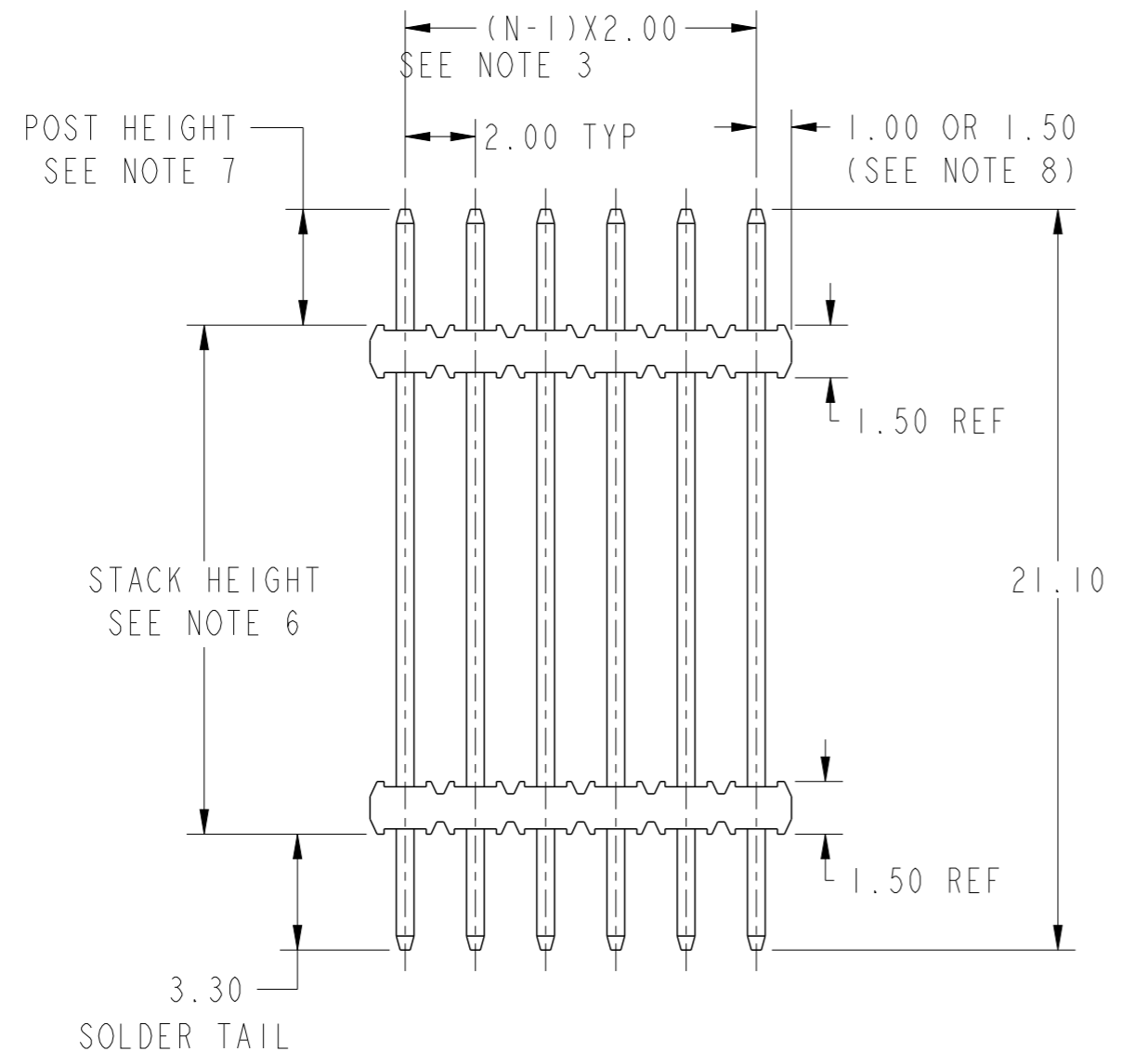

Copyright FCI.

spec ref		dr	Guo-Min Sun	2013/05/15	projection	MM	size	A3	scale	5:1
tolerance std		eng	Guo-Min Sun	2013/07/18			ecn no		ELX-N-14964-1	
TOLERANCES UNLESS OTHERWISE SPECIFIED		chr	-	-			rel level		Released	
surface	<input checked="" type="checkbox"/>	linear	0.X	±0.50		product family	dwg no		10121036	
			0.XX	±0.25			rev		B	
			0.XXX	±0.15			cat. no.		Product - Customer Drw	
		angular	0°	±3°	www.fci.com					

PRODUCT NUMBER DESCRIPTION:
10121036 - X XX X XXX LF

PLATING

S = 0.38um GOLD
ON CONTACT AREA
0.38um GOLD ON TAIL
G = 0.76um GOLD
ON CONTACT AREA
0.76um GOLD ON TAIL
F = 0.20um GOLD
ON CONTACT AREA
0.20um GOLD ON TAIL
T = 0.76um GOLD
ON CONTACT AREA
2.54um 100% MATTE TIN ON TAIL

LEAD FREE

STACK HEIGHT (SEE NOTE 6)

PACKAGING: - = BAGS
(SEE NOTE 5) U = TUBES

POSITIONS PER ROW (02 TO 25)

NOTES:

- MATERIAL HOUSING: HIGH TEMPERATURE THERMOPLASTIC
UL 94V-0, COLOR BLACK
- MATERIAL TERMINAL: COPPER ALLOY
- TO DETERMINE DIMENSIONS:
N=NUMBER OF POSITIONS PER ROW
EX.: 10 POS., N x 2.00 = 20.00 TOTAL POSITIONS
- 0.2kg MIN. PIN RETENTION IN EITHER DIRECTION.
- PACKAGING;
(A) STANDARD PACKAGING: IN POLY BAGS.
(B) SPECIAL PACKAGING: IN TUBE.
FOR ALL SPECIAL PACKAGING,FCI MUST BE CONTACTED FOR
AVAILABILITY IN SIZE REQUESTED.
- STACK HEIGHT IS DETERMINED BY CUSTOMER APPLICATION REQUIREMENTS.
SPECIFIED IN mm. EXAMPLE: 3.7mm STACK
HEIGHT=10121036-XXXX037XLF.

- POST LENGTH IS DETERMINED BY: (OAL)-(3.30)-(STACK HGT.)=POST
LENGTH. MINIMUM MATING LENGTH TO BE 2.0mm
- DIM 1.0 APPLIES TO MOLDED SIDE(S) ONLY. IF SIDE(S) ARE BROKEN,
DIM 1.5 MAX APPLIES.
- OMIT FROM PRODUCT NUMBER IF FEATURE IS NOT APPLICABLE.
- THE HOUSING WILL WITHSTAND EXPOSURE TO 255~C PEAK
TEMPERATURE FOR 10 SECONDS IN A CONVECTION, INFRA-RED
OR VAPOR PHASE REFLOW OVEN.
- THE HOUSING WILL WITHSTAND EXPOSURE TO 260~C PEAK
TEMPERATURE FOR 10 SECONDS IN A WAVE SOLDER
APPLICATION WITH A 1.57MM MINIMUM THICK CIRCUIT BOARD.
- THIS PRODUCT MEETS EUROPEAN UNION DIRECTIVES AND
OTHER COUNTRY REGULATIONS AS DESCRIBED IN GS-22-008.

dr	Guo-Min Sun	2013/05/15	projection	MM	size	A3	scale	1:1
eng	Guo-Min Sun	2013/07/18			ecn no	ELX-N-14964-1		
chr	-	-	product family	-	rel level	Released		
appr	Rick Bian	2013/07/22			www.fci.com	cat. no.	-	Product - Customer Drw
FCI		2.00mm UNSHROUDED HEADER		dwg no	10121036		rev	B
		BOARD TO BOARD THRU-HOLE						



Mouser Electronics

Authorized Distributor

Click to View Pricing, Inventory, Delivery & Lifecycle Information:

[FCI / Amphenol:](#)

[10121036-S03-145LF](#)