

SUMMARY



Wires

| | |
|---------|---|
| Low | 0 |
| High | 0 |
| Coax | 0 |
| Triax | 0 |
| Quad | 0 |
| Fiber | 0 |
| Fluidic | 0 |

Download

[Request a quote](#)

[Catalog](#)

| | |
|------------------|-------------------------|
| Series | 0S |
| Termination type | No contacts / Accessory |
| IP rating | 61 |
| Cable Ø | 0.00 - 0.00 mm |
| Matching parts | xxx |

TECHNICAL DETAILS

Mechanics

| | |
|-------------------|---|
| Shell Style/Model | BRR*: Cap spring loaded dust cap for ERA,ERN and EG receptacle or PSA and PK fixed receptacle |
| Keying | |
| Housing Material | PSU (Polysulfone) shell and collet nut, nickel plated brass latch sleeve and mid pieces |
| Cable Fixing | ∅0 - 0 mm |
| Variant | N : Black |

Performance

| |
|---------------|
| Configuration |
| Insulator |
| Rated Current |

Others

| |
|---------------------------------------|
| Endurance (Shell): 5000 mating cycles |
| Temp (min / max): -50°C / +150°C |
| Axes material: Nickel-plated brass |
| Maximum operating temperature: 100°C |

Watertightness: IP61 according to IEC 60529
IP Rating: 61

DRAWINGS

Draws

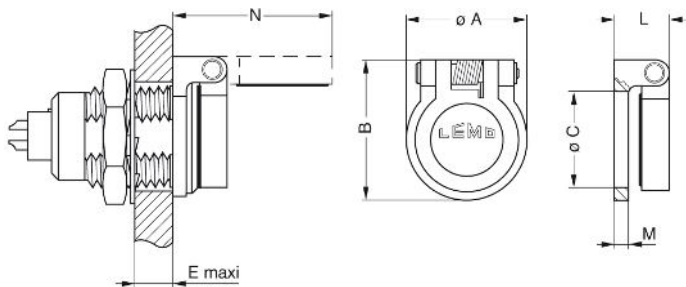

Dimensions

| | A | B | C | E | L | M | N |
|-----|------|------|------|------|------|------|------|
| mm. | 11 | 13.3 | 9 | 5.8 | 5 | 1.2 | 15.3 |
| in. | 0,43 | 0,52 | 0,35 | 0,23 | 0,20 | 0,05 | 0,60 |

RECOMMENDED BY LEMO

Tools

None

Cables