

MICRO SWITCH
a Honeywell Division
FED. MFG. CODE 91929

**BRIDGE PRESSURE
SENSOR**

CATALOG LISTING
136PC05G2

THIS DRAWING COVERS A PROPRIETARY ITEM AND IS THE PROPERTY OF MICRO SWITCH, A DIVISION OF HONEYWELL. THIS DRAWING IS NOT TO BE COPIED OR USED WITHOUT THE APPROVAL OF MICRO SWITCH

GENERAL OPERATING CHARACTERISTICS

PRESSURE RANGE	0 TO 258 mmHg (0 TO 5 PSIG)
OVERPRESSURE	1035 mmHg (20 PSI)
TEMPERATURE RANGES	
STORAGE	-55° TO +125°C
OPERATE	-40° TO +85°C
COMPENSATED	0°C TO +50°C
SUPPLY VOLTAGE	16 VDC MAX
INPUT RESISTANCE	6800 OHM TYP

ELECTRICAL PERFORMANCE AT 10.00 ± .01 VDC SUPPLY AND +25°C

NULL OFFSET	0 ± 1 mV (AT PSI)
F.S.O. / 3	50 ± 1.5 mV (0 TO 5 PSI)
LINEARITY (BFSL)	
INPUT < VENT	± .5% F.S.O. MAX Δ 3
INPUT > VENT	± 1.0% F.S.O. MAX Δ 3
HYSTERESIS & REPEATABILITY	± .15% F.S.O. TYP Δ 3

TEMPERATURE ERROR (25°C TO 0°C OR 25°C TO 50°C)

NULL SHIFT	± 4 mV MAX
SENSITIVITY SHIFT	± 3.0% F.S.O. MAX / 3

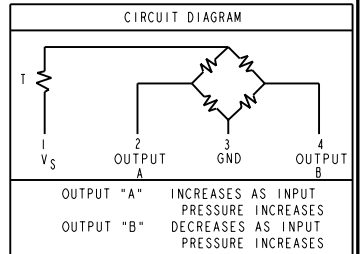
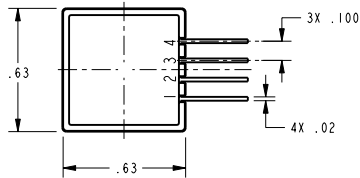
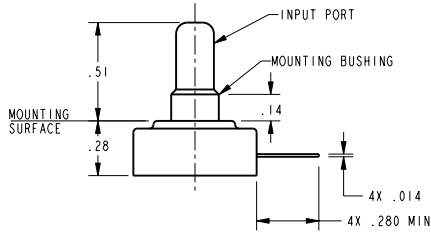
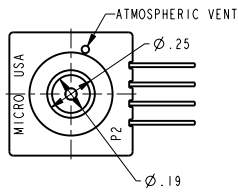

NOTES

- TERMINALS ARE PLATED FOR SOLDERING
- LIMIT SOLDERING TO 315°C MAX FOR 110 SECONDS MAX
F.S.O. IS THE ALGEBRAIC DIFFERENCE BETWEEN THE OUTPUT END POINTS (NULL AND FULL PRESSURE)
- INPUT MEDIA LIMITED ONLY TO THOSE MEDIA THAT WILL NOT ATTACK POLYESTER, SILICON OR SILICONE BASED ADHESIVE

THIRD ANGLE PROJECTION	
SCALE 2 : 1	
DO NOT SCALE PRINT	
UNLESS OTHERWISE SPECIFIED TOLERANCES ARE	
ONE PLACE (.01)	± .030
TWO PLACE (.00)	± .015
THREE PLACE (.000)	± .005
ANGLES	±
WEIGHT	

PTC/CAD 20
 D L T 30 JUL 02
 CHECK SAV 30 JUL 02
 CHECK
 REVISIONS
 A 206109
 0 21
 30 JUL 02
 ISSUE 2
 CATALOG LISTING 136PC05G2
 PAGE 1 OF 1
 RELEASE NO. CO-77378
 REPLACES

ANSI Y14.5M-1982 APPLIES