

Rated cross-section ≤ 2.5 mm²



LPP 7.62/90



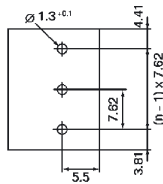
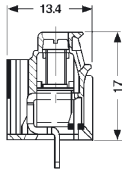

with test point



| Technical Data | | VDE | UL | CSA |
|---------------------|----------------------|------|-----|-----|
| Rated voltage | V | 500* | 300 | 300 |
| Rated current | A | 26 | 15 | 15 |
| Clamping range max. | mm ² /AWG | 4.0 | 12 | 12 |

*Overvoltage category III / Pollution severity 3
Additional technical data see page 59

Solder pin length **3.2 mm** **4.5 mm**

| Colour | |  |  | |
|--------|---------------|---|---|------|
| Poles | Type | Cat. No. | Cat. No. | Qty. |
| 2 | LPP 7.62/2/90 | 1594480000 | 1697240000 | 100 |
| 3 | LPP 7.62/3/90 | 1594490000 | 1697250000 | 100 |

| Accessories | Page |
|---------------|--------|
| Marking | 40 |
| Fixing | 46 |
| Miscellaneous | 43, 46 |

LP 7.62/135



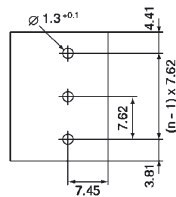
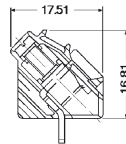

with test point



| Technical Data | | VDE | UL | CSA |
|---------------------|----------------------|------|-----|-----|
| Rated voltage | V | 500* | 300 | 300 |
| Rated current | A | 26 | 15 | 15 |
| Clamping range max. | mm ² /AWG | 4.0 | 12 | 12 |

*Overvoltage category III / Pollution severity 3
Additional technical data see page 59

Solder pin length **3.2 mm** **4.5 mm**

| Colour | |  |  | |
|--------|---------------|---|---|------|
| Poles | Type | Cat. No. | Cat. No. | Qty. |
| 2 | LP 7.62/2/135 | 1595790000 | 1697280000 | 100 |
| 3 | LP 7.62/3/135 | 1595830000 | 1697290000 | 100 |

| Accessories | Page |
|---------------|------|
| Marking | 40 |
| Fixing | - |
| Miscellaneous | 46 |

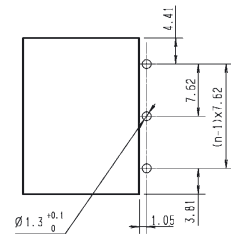
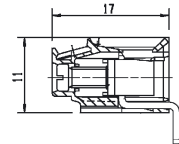

LP 7.62/180



| Technical Data | | VDE | UL | CSA |
|---------------------|----------------------|------|-----|-----|
| Rated voltage | V | 500* | 300 | 300 |
| Rated current | A | 26 | 15 | 15 |
| Clamping range max. | mm ² /AWG | 4.0 | 12 | 12 |

*Overvoltage category III / Pollution severity 3
Additional technical data see page 59

Solder pin length **3.2 mm** **4.5 mm**

| Colour | |  |  | |
|--------|---------------|---|---|------|
| Poles | Type | Cat. No. | Cat. No. | Qty. |
| 2 | LP 7.62/2/180 | 1753890000 | 1753910000 | 100 |
| 3 | LP 7.62/3/180 | 1753900000 | 1753920000 | 100 |

| Accessories | Page |
|---------------|------|
| Marking | 40 |
| Fixing | 46 |
| Miscellaneous | 46 |

Rated cross-section ≤ 2.5 mm²