

## REVISIONS

## RELEASED

REV.	DESCRIPTION	DATE	APPROVED
H	22667 UPDATED P/LIST	2-1-93	
J	22814 ITEM 2 WAS 16043-001	2/18/93	
K	22949 REDRAWN TO CAEDS	3-1-93	
L	24910 ADDED ITEMS 16 & 18	10-13-93	WS
M	11-024834 ITEM 6 WAS -054	11-12-01	CB

FAA/PMA

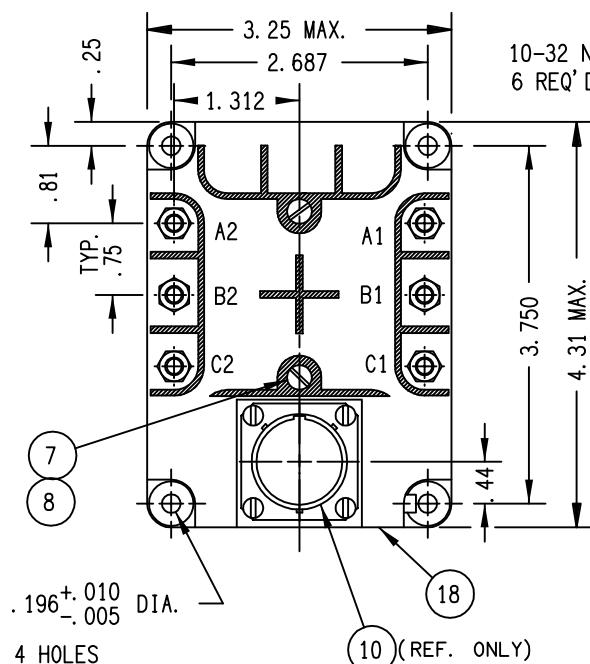

VENT (LOCATION OPT.)

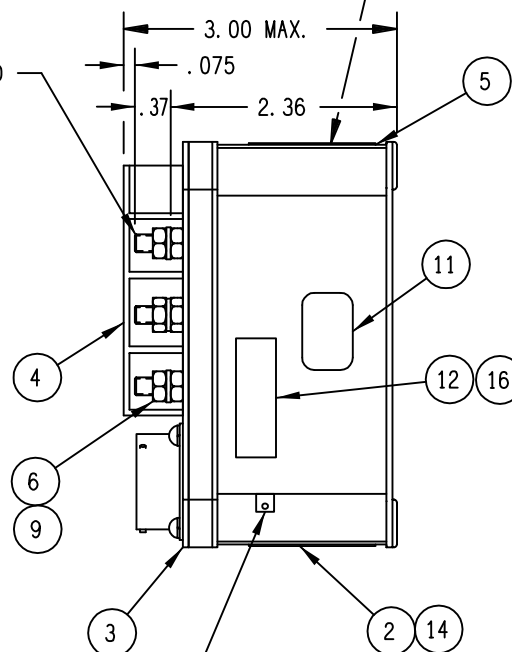

CONSTRUCTION  
MAIN CONTACT  
CONFIGURATION  
VOLTAGE  
CURRENT: RES.  
IND.  
RUPTURE

GASKET SEALED (VENTED)

3 PST N.O.  
115/200 VAC, 300 TO 600 HZ  
60 AMPS  
60 AMPS  
600 AMPS

COIL DATA  
NOMINAL VOLTAGE  
RATING VOLTAGE  
PICKUP MAX.  
DROPOUT VOLTAGE  
CLOSING TIME  
DROPOUT TIME  
INRUSH CURRENT  
HOLDING CURRENT

28 VDC  
18 TO 32 VDC  
18 VDC  
1-9 VDC  
35 MS MAX. AT 28 VDC  
35 MS MAX. AT 28 VDC  
3 AMP MAX.  
315 MA MAX.

AUXILIARY CONTACTS  
CONFIGURATION  
VOLTAGE  
CURRENT: RES.  
IND.  
LAMP

4 PDT  
28 VDC OR 200 VAC 400 HZ  
5 AMPS  
2 AMPS  
1 AMP

ENVIRONMENTAL DATA  
OPERATING TEMP.  
LIFE ELECTRICAL  
WEIGHT MAX.

-55°C MIN. TO +85°C MAX.  
50,000 CYCLES MIN.  
1 LB. 12 OZ.

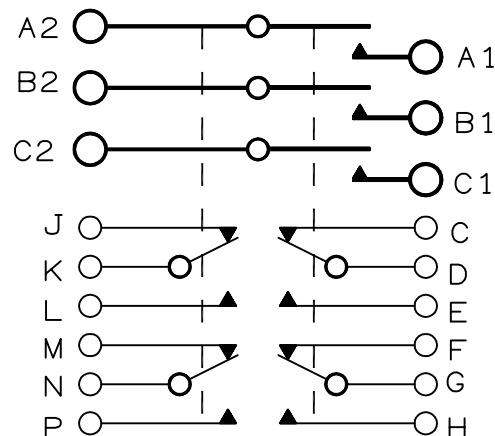

18	1	57200-057	YELLOW DOT			
16	1	39529-047	OVERLAY			
14	1	39529-001	OVERLAY			
13	1	39529-002	OVERLAY			
12	1	58400-070	PLATE - FAA/PMA			
11	1	25695-001	WARNING DECAL			
10	-	52516-013	CONNECTOR - BENDIX		MS3470L-16-26P	
9	6	51810-054	WASHER - LOCK NO. 10 .062 X .047		AN935B10	BRONZE
8	2	51806-031	WASHER - LOCK NO. 6 INT.		AN936A6B	BRONZE
7	2	51206-644	SCREW - 6-32 X 3/4 RD. HD.			BRASS
6	6	50410-174	NUT - 10-32 X 5/16 X 9/64 HEX.			BRASS
5	1	38031-010	CONTACTOR ASSEMBLY - PRIMARY			
4	1	22295-001	SHIELD - TERMINAL			
3	1	38035-001	PLATE - BASE COVER			
2	1	16043-067	PLATE - NAME			
1	1	38036-001	PLATE - WIRING DIAGRAM			

FIND NO	QTY REQD	PART OR IDENTIFYING NO	NOMENCLATURE OR DESCRIPTION	FSCM NO	DRAWING OR SPECIFICATION	MATERIAL OR NOTE
---------	----------	------------------------	-----------------------------	---------	--------------------------	------------------

UNLESS OTHERWISE SPECIFIED  
DIMENSIONS ARE IN INCHES  
TOLERANCES ON

2 PL DEC. 3 PL DEC. ANGLES  
± .06 ± .010 ± 1°

REF.  
24-41-14



Hartman Division 175 N. DIAMOND STREET MANSFIELD, OHIO 44902

DR BY HEA 93/11/11  
CHK BY WS 93/11/18  
ENGR KLK 93/12/01  
MFG JF 93/12/02

SIZE CODE IDENT  
C 74063

SCALE NONE SHEET

CONTACTOR - TPST NO  
093

DWG NO. B-138S

REF TE P/N 1616002-5

# Mouser Electronics

Authorized Distributor

Click to View Pricing, Inventory, Delivery & Lifecycle Information:

[TE Connectivity:](#)

[1616002-5](#)