

PRINT TEXT(COLOR:WHITE)

79.00

10.00

MOLEX  
ISM 868/915  
105262

A  
2.5MAX  
WITH SOLDER PASTE

VERTICAL DIRECTION SEE NOTE2

6.50  
L ±1.00

Ø 1.13 ±0.05

SOLDER MUST COVER HATCH AREAS

CABLE

CONNECTOR

LPI SOLDER MASK(10um)  
PATTERN Cu(18~20um)  
PI(50um)  
ADHESIVE(3M467)  
RELEASE PAPER

0.13 ±0.03

DETAIL A  
FLEX LAYER

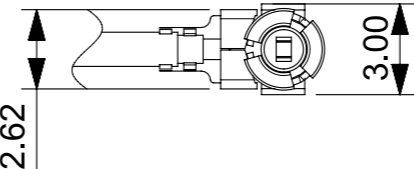
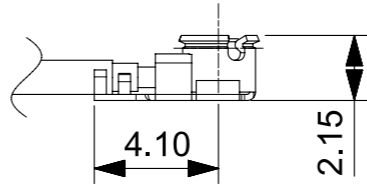

CANNECTOR



3D VIEW

ITEM	MATERIAL NO.	CABLE LENGTH "L"
1	1052620001	93.6mm
2	1052620002	143.6mm
3	1052622001	193.6mm

- NOTE:
- MATERIAL:FLEX SEE FLEX LAYER  
CONNECTOR:OD1.13,2.5H UFL CONNECTOR(COLD PLATED)
  - CAN NOT LIFE UP CABLE IN VERTICAL DIRECTION
  - NI & Au PLATING ON SOLDER PADS ONLY  
NI:1-3um  
Au:MIN 0.1um THICKNESS
  - COVER COAT:BLACK
  - APPLICATION SPEC PLEASE REFER TO AS OF AS-105262-001
  - PRODUCT SPEC PLEASE REFER TO PS OF PS-105262-001
  - PACKAGING DRAWING PLEASE REFER TO PK OF PK-105262-001

THIS DRAWING CONTAINS INFORMATION THAT IS PROPRIETARY TO MOLEX ELECTRONIC TECHNOLOGIES, LLC AND SHOULD NOT BE USED WITHOUT WRITTEN PERMISSION												
QUALITY SYMBOLS	EC NO: 122214 DRWN: Kang Cheng CHK'D: Colin Xu APPR: Stary Song	GENERAL TOLERANCES (UNLESS SPECIFIED)		DIMENSION UNITS	SCALE	 868/915MHz ISM STAND ALONE ANTENNA PRODUCT DESIGN DRAWING						
		ANGULAR TOL ± 0.5 °		mm	3:1							
		4 PLACES ± 0.00000	3 PLACES ± 0.05	DRWN BY: Kang Cheng								DATE: 2017/09/22
		2 PLACES ± 0.15	1 PLACE ± 0.2	CHK'D BY: Colin Xu								DATE: 2017/09/22
0 PLACES ± 0.5	DRAFT WHERE APPLICABLE MUST REMAIN WITHIN DIMENSIONS		APPR BY: Stary Song		DATE: 2017/09/22	SERIES: 105262		MATERIAL NUMBER: SEE TABLE		CUSTOMER: GENERAL MARKET		
DRAWING SIZE: A3		THIRD ANGLE PROJECTION		DOCUMENT NUMBER: SD-105262-001								
						DOC TYPE: PSD		DOC PART: SD		SHEET NUMBER: 1 OF 1		

RELEASE STATUS	RELEASE DATE
----------------	--------------