

THERMOPLASTIC FUSE RATED 36V

RoHS



Description

Consisting of a heat resistant body, the fuse element stretches over the exterior of the body from end to end. The body varies in color indicating the current ratings.

Specifications

Complies with: DIN 72581-1

Ordering Information

Part Number	Package Size
0214xxx.LXN	50
0214xxx.K	10000

Dimensions

Dimensions in mm

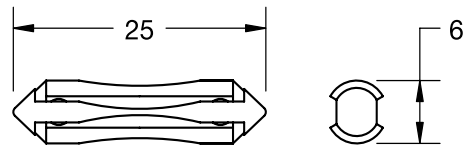

Ratings

Part Number	Current Rating	Housing Color	Typ. Voltage Drop Littelfuse max
0214005_	5A	Yellow	50mV
0214008_	8A	White	50mV
0214016_	16A	Red	50mV
0214025_	25A	Blue	50mV
0214040_	40A	Grey	50mV

Mouser Electronics

Authorized Distributor

Click to View Pricing, Inventory, Delivery & Lifecycle Information:

Littelfuse:

[0214016.Z](#) [0214008.Z](#) [0214005.Z](#) [0214025.Z](#) [0214005.LXN](#) [0214008.LXN](#) [0214016.LXN](#) [0214016.K](#)
[151.5100.4506](#) [0214005.K](#) [0214025.K](#) [0214008.K](#) [0214025.LXN](#) [0214040.LXN](#)