

DATE	SYM	REVISION RECORD	AUTH.	DR.	CK.
5/23/97	-	REDRAWN	IK	NT	MM

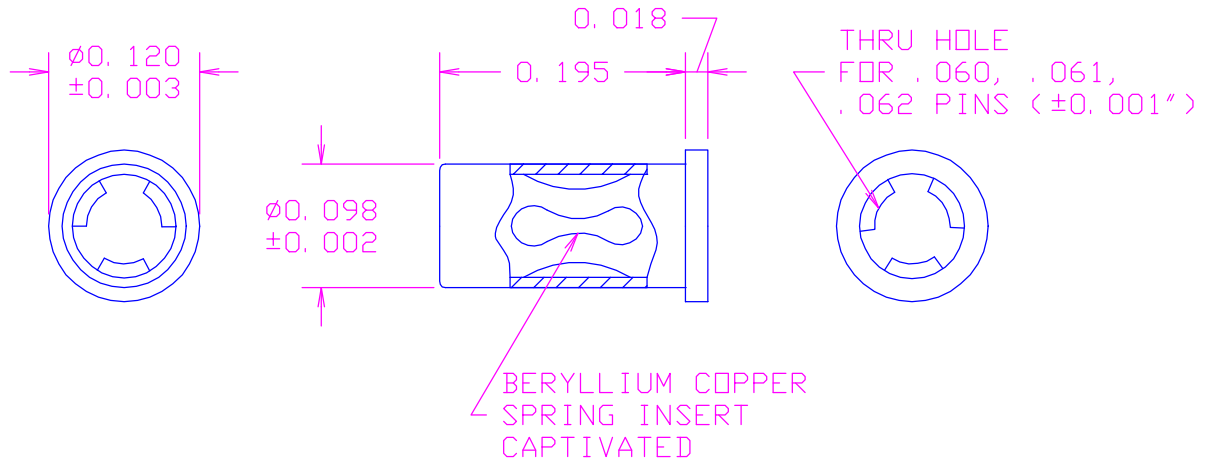

RECOMMENDED MOUNTING HOLE  $.102 \pm .001$  DIA. (#38 DRILL)  
 USE ONE SIZE PIN ONLY—  
 NOT RECOMMENDED FOR SMALLER PIN USE  
 AFTER LARGER PIN HAS BEEN USED

FINISH CODE	COMPONENT	MATERIAL	FINISH
03	BODY	BRASS PER ASTM B16	.000010" GOLD PER MIL-G-45204, TYPE II, GRADE C
	SPRING	BERYLLIUM COPPER PER ASTM B194	.000030" GOLD PER MIL-G-45204, TYPE II, GRADE C
04	BODY	BRASS PER ASTM B16	.0001" ELECTRO-TIN OVER .0001" NICKEL PER MIL-T-10727
	SPRING	BERYLLIUM COPPER PER ASTM B194	.0002" BRIGHT ELECTRO-TIN OVER .000050" NICKEL PER MIL-T-10727
06	BODY	BRASS PER ASTM B16	.0001" ELECTRO-TIN OVER .0001" NICKEL PER MIL-T-10727
	SPRING	BERYLLIUM COPPER PER ASTM B194	.000030" GOLD PER MIL-G-45204, TYPE II, GRADE C

ACTUAL SIZE



TOLERANCES (EXCEPT AS NOTED)		CONCORD ELECTRONICS CORPORATION	
DECIMAL $\pm .010$	P/N	SCALE	30 GREAT JONES ST. NEW YORK N. Y. 10012
FRACTIONAL $\pm 1/64$	TITLE P.C. JACK FOR .060, .061, .062 PINS		
ANGULAR $\pm 5^\circ$	DATE 4-22-97	DRAWING NUMBER 09-9159-1-XX	