

Shock-Safe Fuseholder, 5 x 20 mm, Slotted Cap, IP 67



Variant 2

250 VAC · 2.5 W / 10 A (VDE) 10 A (UL/CSA)



**Description**

- IP 67 from Front and Rear-Side
- Screw type fuse carrier

**Standards**

- IEC 60127-6
- UL 4248-1
- CSA 22.2 no. 4248.1

**Approvals**

- VDE Certificate Number: 133472
- UL File Number: E39328

**Weblinks**

[pdf-datasheet](#), [html-datasheet](#), [General Product Information](#), [Approvals](#), [CE declaration of conformity](#), [RoHS](#), [CHINA-RoHS](#), [REACH](#), [e-Shop](#), [SCHURTER-Stock-Check](#), [Distributor-Stock-Check](#), [Detailed request for product](#)

**Technical Data**

|                              |  |                                 |   |
|------------------------------|--|---------------------------------|---|
| Shock-Safe Category          | PC2  | Soldering Methods               | Iron<br><a href="#">Soldering Profile</a>                       |
| Fuse-Link                    | 5 x 20 mm  | Solderability                   | 350 °C / 2 sec acc. to IEC 60068-2-20, Test Ta, method 2        |
| Mounting                     | Panel Mount, Front Side  | Resistance to Soldering Heat    | 350 °C / 10 sec acc. to IEC 60068-2-20, Test Tb, method 2       |
| Attachment                   | Fixing Nut   | Contact Resistance              | < 5 mΩ at 20 mV   |
| Terminal                     | Solder or Quick-Connect 2.8 x 0.5 mm   | Dielectric Strength             | > 3 kV<br>> 4 kV between L/N-PE (50 Hz; 1 min)                  |
| Rated Voltage                | 250 VAC  | Impulse Withstand Voltage       | > 4 kV between L-N<br>> 6 kV between L/N-PE                     |
| Rated current                | 10 A (VDE), 10 A (UL/CSA)  | Insulation Resistance           | > 10 MΩ between L-N<br>> 100 MΩ between L/N-PE (500 VDC; 1 min) |
| Rated Power Acceptance IEC   | 2.5 W / 10 A @ Ta 23 °C<br>Admissible power acceptance at higher ambient temperature see derating curves | Overvoltage Category            | I - III acc. to IEC 60664-1                                     |
| Degree of Protection         | IP 67  | Pollution Degree                | 1 - 3 acc. to IEC 60664-1                                       |
| Protection Class             | Suitable for appliances with protection class I or II acc. to IEC 61140                                  | Admissible Torque on Fixing Nut | max 1.2 Nm  |
| Admissible Ambient Air Temp. | -40 °C to 85 °C  | Panel Thickness s               | max 6 mm  |
| Climatic Category            | 40/085/21 acc. to IEC 60068-1  |                                 |   |
| Material: Socket             | Thermoset, black, UL 94V-0   |                                 |   |
| Material: Terminals          | Tin-Plated Copper Alloy  |                                 |   |
| Unit Weight                  | 5.95 g   |                                 |   |
| Storage Conditions           | 0 °C to 60 °C, max. 70% r.h.   |                                 |   |
| Product Marking              | ☐, Type, Rated voltage, Rated current, Approvals   |                                 |   |

**Dimension**

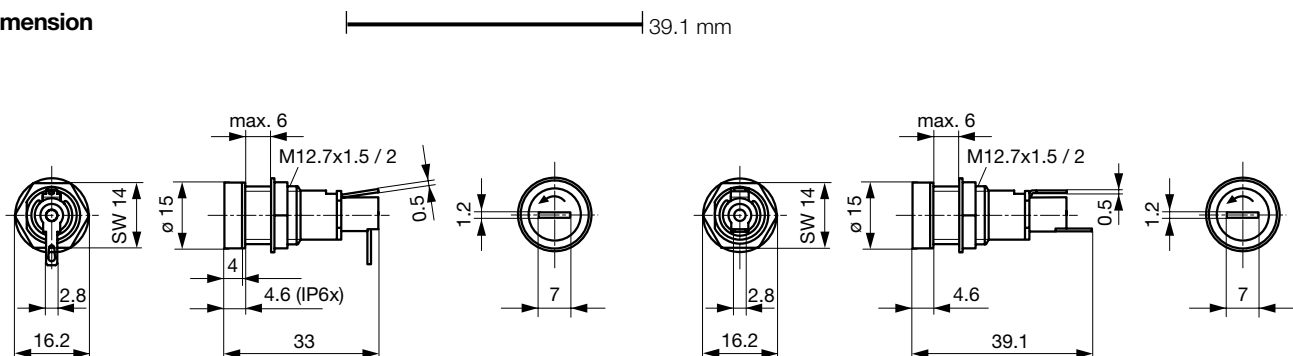

Variants 0031.1363 and 0031.1383

Variant 0031.1351

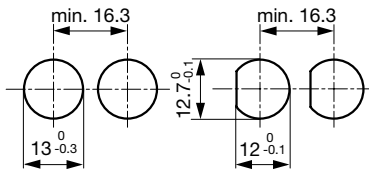

Mounting holes

Derating Curves

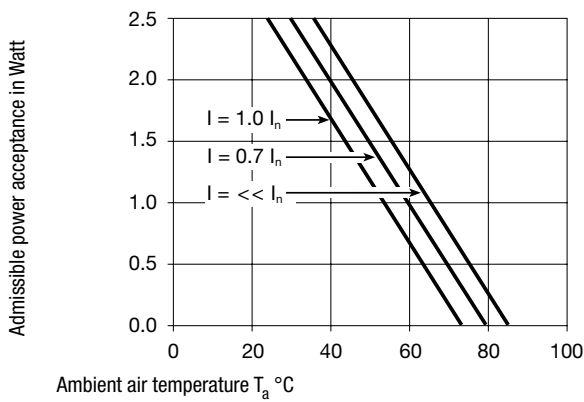

All Variants

| Holder | Cap     | Terminal | Position End-Terminal | Degree of Protection | Order Number |
|--------|---------|----------|-----------------------|----------------------|--------------|
| ●      | slotted | Solder   | Straight to Fuse Axis | IP 67                | 0031.1351    |
| ●      | slotted | Solder   | 90° to Fuse Axis      | IP 67                | 0031.1353    |

Most Popular.

Availability for all products can be searched real-time:<http://www.schurter.com/Stock-Check/Stock-Check-SCHURTER>

Quick-Connect Terminals on Request

Packaging Unit Bulk (100 pcs.)