

REVISIONS			
REV	DESCRIPTION	DATE	APPRD
K	PRODUCT DRAWING (EAR 13638)	DEC09/09	K.L.

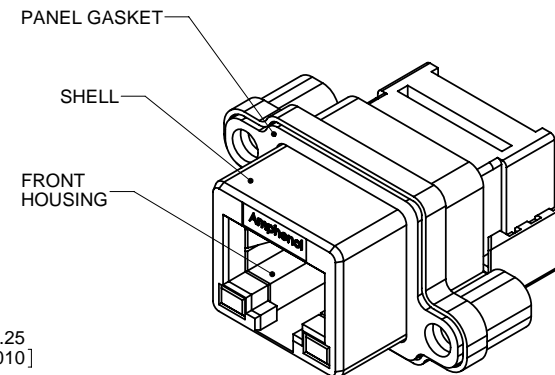
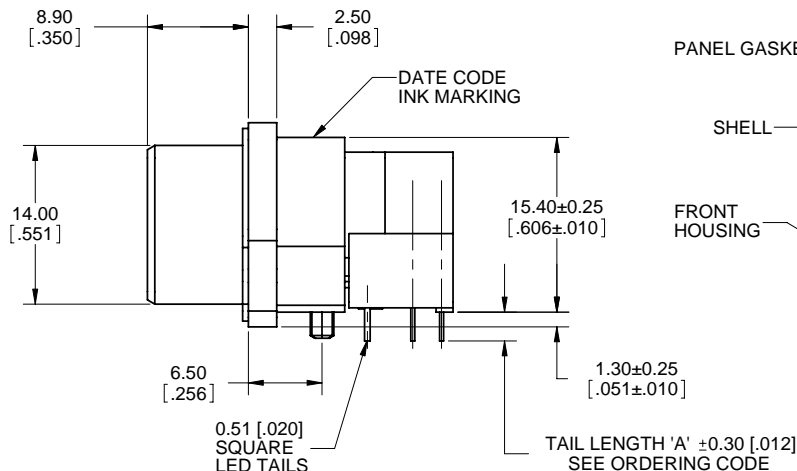
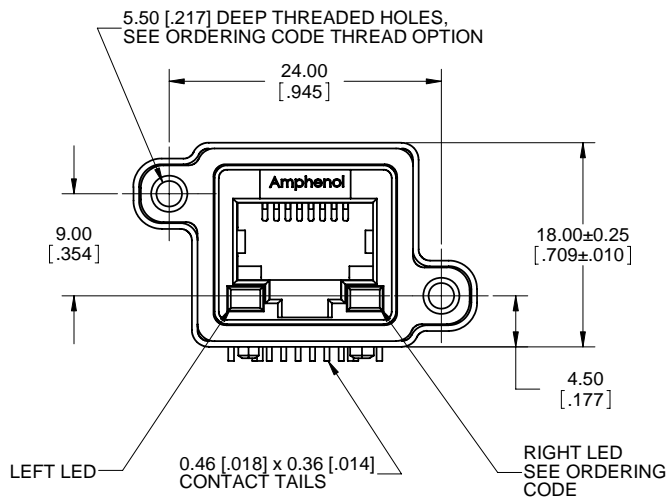

ORDERING CODE: M R J - 5 3 X X - X 1

SERIES, RUGGED RJ  
RECEPTACLE, RIGHT ANGLE, PCB TAIL

NUMBER OF CONTACTS  
8= 8 CONTACTS  
A=10 CONTACTS

LED OPTION  
0=NONE  
1=GREEN LEFT, YELLOW RIGHT  
4=YELLOW LEFT, GREEN RIGHT  
5=GREEN LEFT, GREEN RIGHT  
A=BI-COLOUR GREEN/YELLOW LEFT  
BI-COLOUR GREEN/YELLOW RIGHT  
D=GREEN LEFT  
BI-COLOUR GREEN/YELLOW RIGHT  
E=YELLOW LEFT  
BI-COLOUR GREEN/YELLOW RIGHT

TAIL LENGTH AND MOUNTING HOLE THREAD OPTION  
0= TAIL LENGTH A=2.54 [.100], #4-40 UNC THREAD  
B= TAIL LENGTH A=3.81 [.150], #4-40 UNC THREAD  
M= TAIL LENGTH A=2.54 [.100], M3 x 0.5 THREAD  
P= TAIL LENGTH A=3.81 [.150], M3 x 0.5 THREAD

SINGLE PORT

#### NOTES:

- MATERIAL:**  
ALL MATERIALS ARE RoHS COMPLIANT PER EU DIRECTIVE 2002/95/EC AND AMENDMENTS
  - SHELL - DIECAST ZINC, NICKEL PLATED
  - CONTACTS - PHOSPHOR BRONZE WITH 50 MICROINCHES (1.27 MICRONS) GOLD OVER 50 MICROINCHES (1.27 MICRONS) MINIMUM NICKEL ON THE MATING AREA AND MATTE TIN OVER NICKEL ON THE CONTACT TAILS.
  - INSERTS - ENGINEERING THERMOPLASTIC, UL FLAMMABILITY RATING 94V-0, REAR INSERTS: BLACK NYLON, FRONT INSERT: CLEAR POLYCARBONATE
  - LED'S - EPOXY LENS, STEEL TAILS WITH TIN PLATING
  - GASKET - SILICONE RUBBE
- ENVIRONMENTAL PERFORMANCE PER IEC 60529 CODE IP67 FOR SEAL BETWEEN MATING AREA AND PCB SIDE OF CONNECTOR. GASKET PROVIDES SEAL TO INSIDE FACE OF PANEL.
- CURRENT RATING: 1.5 AMPERES
- CONTACT RESISTANCE: 30 MILLIOHMS MAXIMUM
- OPERATING TEMPERATURE: -40°C TO +105°C
- LED CHARACTERISTICS: FORWARD DC CURRENT 25 mA MAX., FORWARD VOLTAGE 2.5 V MAX@ 2 mA
- AVAILABLE MATING AREA COVERS PROVIDE ADDED PROTECTION. CONSULT WITH AMPHENOL CANADA FOR DETAILS.
- CUSTOMER TO VERIFY THAT ALL PROCESS CLEANERS ARE COMPATIBLE WITH POLYCARBONATE MATERIAL.

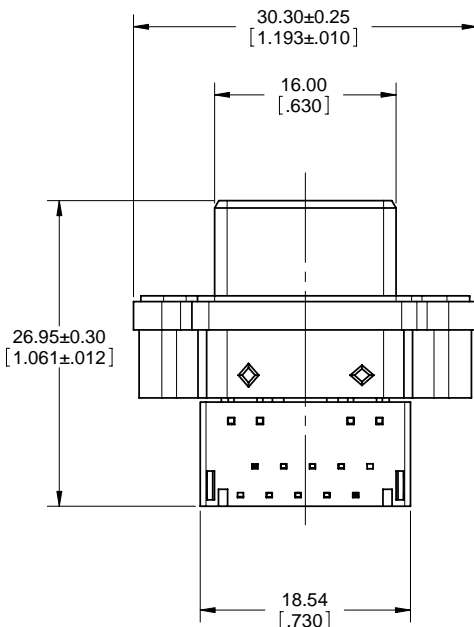

UNLESS OTHERWISE SPECIFIED DIMENSIONS ARE IN MILLIMETERS TOLERANCES ARE:		APPROVALS		DATE	Amphenol Canada Corp.			
DECIMALS XX ± 0.15 X ±		ANGLES ±		DRAWN S.SEMENOV				
MATERIAL AND FINISH		DESIGNED S.SEMENOV		NOV11/04	TITLE	MRJ SERIES RUGGED MODULAR JACK, 8 & 10 POSITION RIGHT ANGLE, WITH LED, TAIL LENGTH & THREAD OPTIONS, RoHS COMPLIANT		
		CHECKED						
		QA APP'D						
REF.		IE APP'D			SIZE	DWG. NO.	REV.	
					C	P-MRJ-53XX-X1	K	
CODE IDENT. NO.		DWG APP'D		A.GREEN	NOV11/04	SCALE	PROJECT	SHEET
						3:1	----	1 OF 2

### RECOMMENDED P.C.B. LAYOUT (COMPONENT SIDE OF BOARD)



DO NOT SCALE DRAWING  
THIS DOCUMENT CONTAINS PROPRIETARY INFORMATION AND SUCH INFORMATION MAY NOT BE DISCLOSED TO OTHERS FOR ANY PURPOSE  
OR USED FOR MANUFACTURING PURPOSES WITHOUT PERMISSION FROM AMPHENOL CANADA CORP.

