

NO. OF POSITIONS x .100[2.54]
(MOLD TO POSITION: $^{+0.000}_{-0.005}$ [0.00] - $^{+0.000}_{-0.005}$ [0.13])
(CUT TO POSITION: ± 0.008 [.20] - SEE NOTE 4)

(NO. OF POS x .100[2.54]) - (.100[2.54])

"B"

-02

.050[1.27] REF

.100[2.54] REF

-50

-49

-01

"B"

1st POSITION

"A"

-50

-02

.200[5.08] REF

.100[2.54] REF

-49

-01

POLARIZING OPTION
INSERT PK-06-N INTO SPECIFIED
POS AND BREAK OFF TAB
(NOT AVAILABLE FOR -BE OPTION)

- T: MATTE TIN CONTACT AND TAIL
- L: 10µ" LIGHT SELECTIVE GOLD IN CONTACT AREA,
MATTE TIN ON TAIL
- F: 3µ" FLASH SELECTIVE GOLD CONTACT AREA,
MATTE TIN ON TAIL
- S: 30µ" SELECTIVE GOLD IN CONTACT AREA,
MATTE TIN ON TAIL
- H: 30µ" HEAVY GOLD IN CONTACT AREA,
3µ" GOLD ON TAIL
- SM: 30µ" SELECTIVE GOLD IN CONTACT AREA,
MATTE TIN ON TAIL
- TM: MATTE TIN CONTACT AND TAIL
- LM: 10µ" LIGHT SELECTIVE GOLD IN CONTACT AREA
MATTE TIN ON TAIL
- FM: 3µ" FLASH SELECTIVE GOLD IN CONTACT AREA,
MATTE TIN ON TAIL
- LTL: 10µ" LIGHT SELECTIVE GOLD IN CONTACT AREA
TIN LEAD (90/10 +/-5%) ON TAIL

- DE: DUAL ENTRY (SEE TABLE 1)
- TE: TOP ENTRY (SEE TABLE 1)
- HE: HORIZONTAL ENTRY (SEE TABLE 1)
- PE: PASS-THROUGH ENTRY (SEE TABLE 1)
- DE-BE: (SEE TABLE 1)
- PE-BE: (SEE TABLE 1)

-S: SINGLE ROW (SEE TABLE 1)
-D: DOUBLE ROW (SEE TABLE 1)

TABLE 1			
ENTRY SPEC	BODY SPEC	CONTACT #1	CONTACT #2
-S-DE (SEE FIG.1)	SSM-XX-S	C-95-01-X	-----
-D-DE (SEE FIG.1)	SSM-XX-D	C-95-01-X	-----
-S-TE (SEE FIG.3)	SSM-XX-S	C-95-09-X	-----
-D-TE (SEE FIG.3)	SSM-XX-D	C-95-09-XXX	-----
-S-HE (SEE FIG.2)	BCH-XX-S	C-58-05-X	-----
-D-HE (SEE FIG.2)	BCH-XX-D	C-58-04-X	C-58-03-X
-S-PE (SEE FIG.4)	SSM-XX-S	C-166-10-X	-----
-D-PE (SEE FIG.4)	SSM-XX-D	C-166-10-X	-----
-S-DE-BE (SEE FIG.1)	SSM-XX-S-BE	C-95-01-X	-----
-D-DE-BE (SEE FIG.1)	SSM-XX-D	C-95-01-X	-----
-S-PE-BE (SEE FIG.4)	SSM-XX-S-BE	C-166-10-X	-----
-D-PE-BE (SEE FIG.4)	SSM-XX-D	C-166-10-X	-----

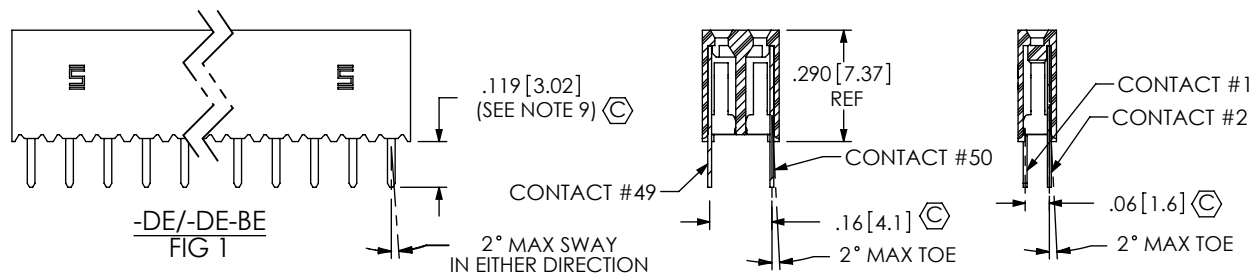

SECTION "A"-"A"
BCS-1XX-X-D-DE

SECTION "B"- "B"
BCS-1XX-X-S-DE

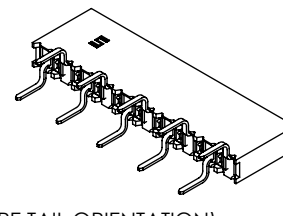
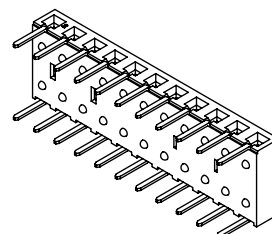
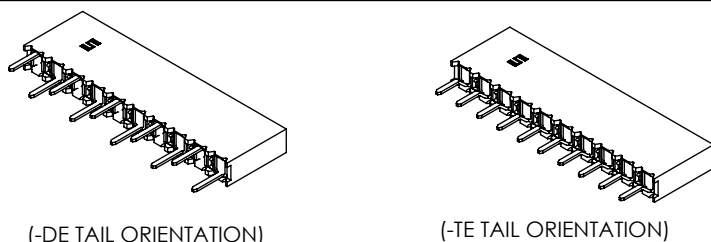

1. ☉ REPRESENTS CRITICAL DIM. FOR STATISTICAL PROCESS CONTROL.
2. PUSHOUT FORCE TO BE: 1 lb. MIN.
3. [] DIMENSIONS ARE IN MILLIMETERS.
4. MIN WALL THICKNESS ON CUT PARTS: .009 [.23].
5. CUT PARTS TO BE SYMMETRICAL ABOUT C.
6. 1st POSITION WILL ALWAYS POINT UP ON TOP VIEW AS SHOWN.
7. 1 THROUGH 4 POSITIONS ARE TO BE LAYER PACKAGED, 5 THROUGH 50 POSITIONS ARE TO BE TUBED FOR THIS PART NUMBER.
8. DAMAGE TO THE CUT SURFACE CAN NOT EFFECT LEAD-IN OF THE CORES.
9. MAX VARIATION WITHIN A ROW: .006 [.15]
MAX VARIATION FROM ROW TO ROW: .012 [.30]

UNLESS OTHERWISE SPECIFIED.
DIMENSIONS ARE IN INCHES.
TOLERANCES ARE:

DECIMALS	ANGLES
.XX: $\pm .01$ [.3]	2°
.XXX: $\pm .005$ [.13]	
.XXXX: $\pm .0020$ [.051]	

THIS DOCUMENT CONTAINS INFORMATION
CONFIDENTIAL AND PROPRIETARY TO
SAMTEC, INC. AND SHALL NOT BE REPRODUCED
OR TRANSFERRED TO OTHER DOCUMENTS OR
DISCLOSED TO OTHERS OR USED FOR ANY
PURPOSE OTHER THAN THAT WHICH IT WAS
OBTAINED WITHOUT THE EXPRESSED WRITTEN
CONSENT OF SAMTEC, INC.

MATERIAL: DO NOT SCALE DRAWING SHEET SCALE: 2:
INSULATOR: GLASS FILLED LCP UL 94 VO, COLOR: BLACK
CONTACT: PHOS. BRONZE

F:\DWG\MISC\MKTG\BCS-1XX-XXX-X-XX-XXX-MKT.SLDDRW

samtec

520 PARK EAST BLVD, NEW ALBANY, IN 47150
PHONE: 812-944-6733 FAX: 812-948-5047
e-Mail info@SAMTEC.com code 55322

DESCRIPTION: BOX CONNECTOR SOCKET STRIP

DWG. NO. BCS-1XX-XXX-X-XX-XXX

BY: KOLB	09/12/1991	SHEET 1 OF 3
----------	------------	--------------

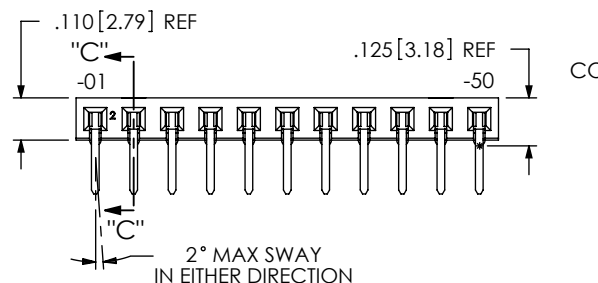

BCS-1XX-X-S-HE

FIG 2
-HE

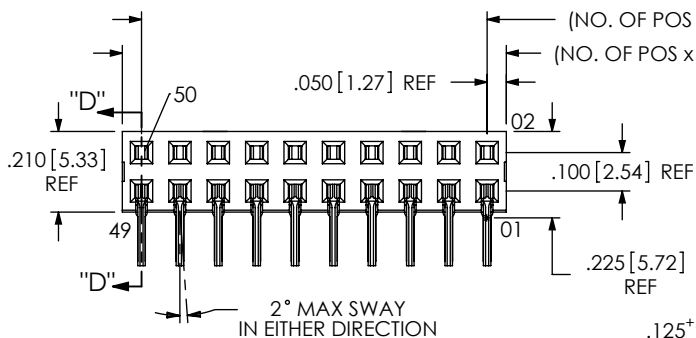
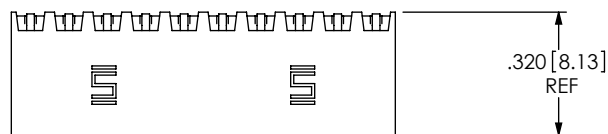

BCS-1XX-X-D-HE

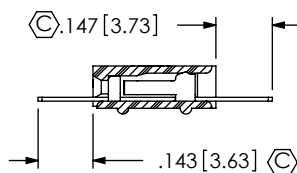

IN-PROCESS
-S-HE

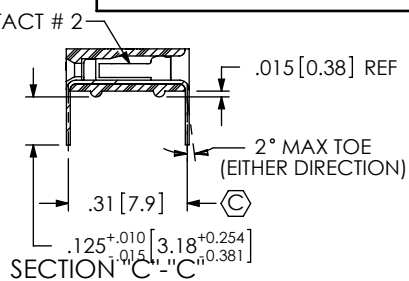

SECTION "C"-"C"

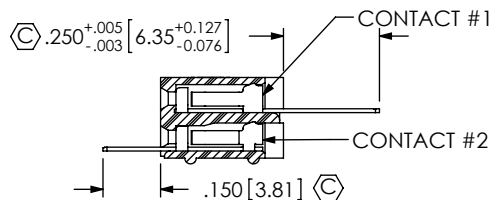

IN-PROCESS
-D-HE

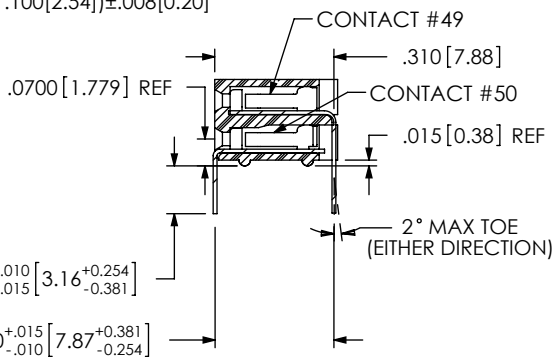

SECTION "D"-"D"

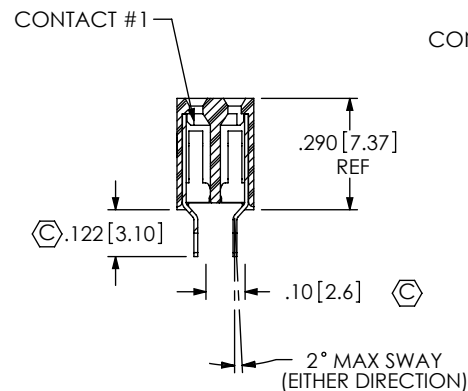

BCS-1XX-XXX-D-TE

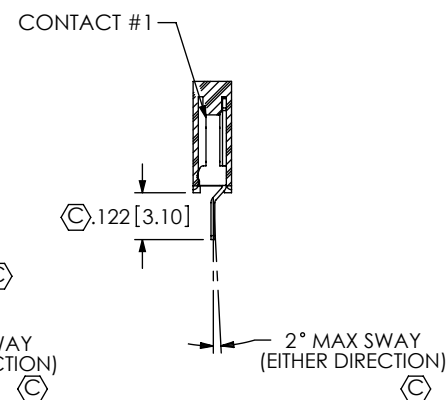

BCS-1XX-X-S-TE

FIG 3
-TE

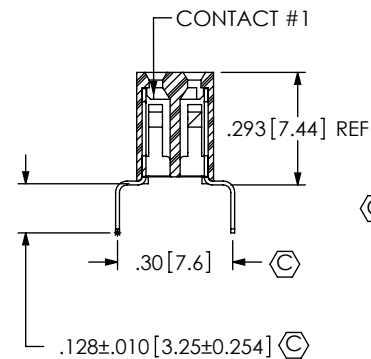

BCS-1XX-XXX-D-PE

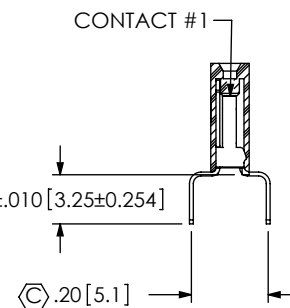

BCS-1XX-X-S-PE

FIG 4
-PE/-PE-BE
(SEE SHEET 3 FOR IN-PROCESS)

PROPRIETARY NOTE
THIS DOCUMENT CONTAINS INFORMATION
CONFIDENTIAL AND PROPRIETARY TO
SAMTEC, INC. AND SHALL NOT BE REPRODUCED
OR TRANSFERRED TO OTHER DOCUMENTS OR
DISCLOSED TO OTHERS OR USED FOR ANY
PURPOSE OTHER THAN THAT WHICH IT WAS
OBTAINED WITHOUT THE EXPRESSED WRITTEN
CONSENT OF SAMTEC, INC.

DO NOT SCALE DRAWING

SHEET SCALE: 2:1

samtec

520 PARK EAST BLVD, NEW ALBANY, IN 47150
PHONE: 812-944-6733 FAX: 812-948-5047
e-Mail info@SAMTEC.com code 55322

DESCRIPTION: BOX CONNECTOR SOCKET STRIP

DWG. NO. BCS-1XX-XXX-X-XX-XXX

BY: KOLB 09/12/1991 SHEET 2 OF 3

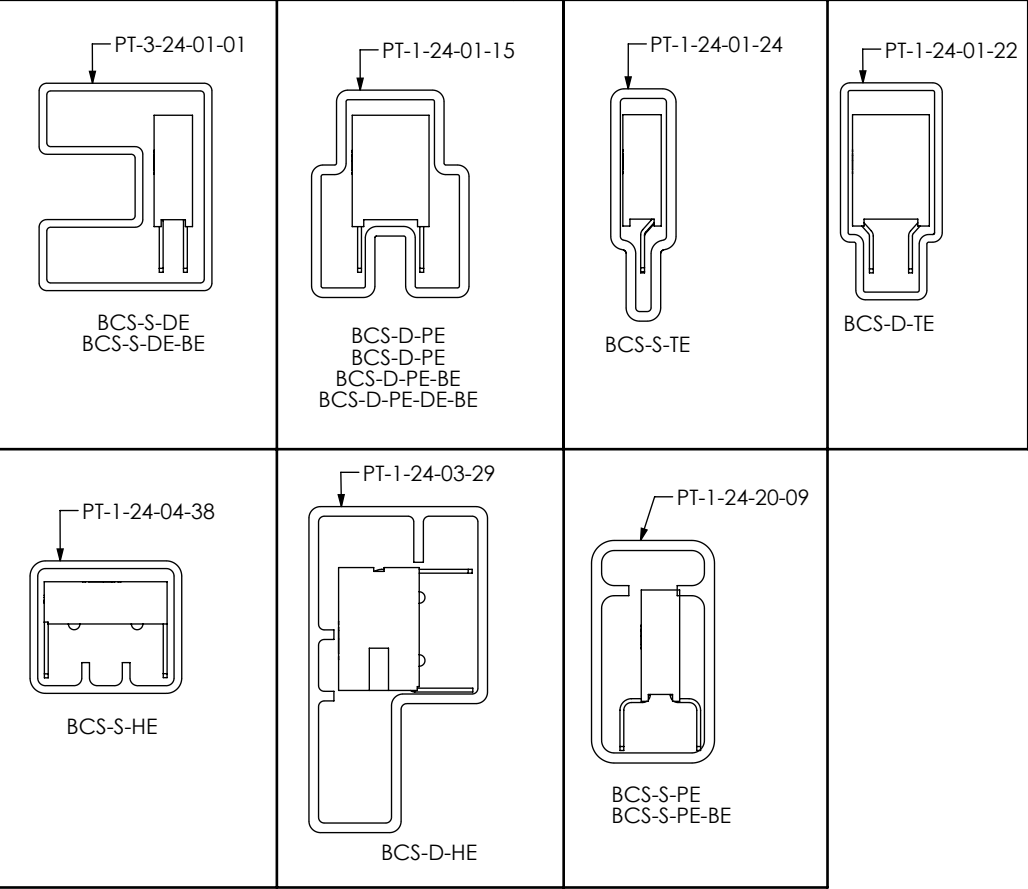
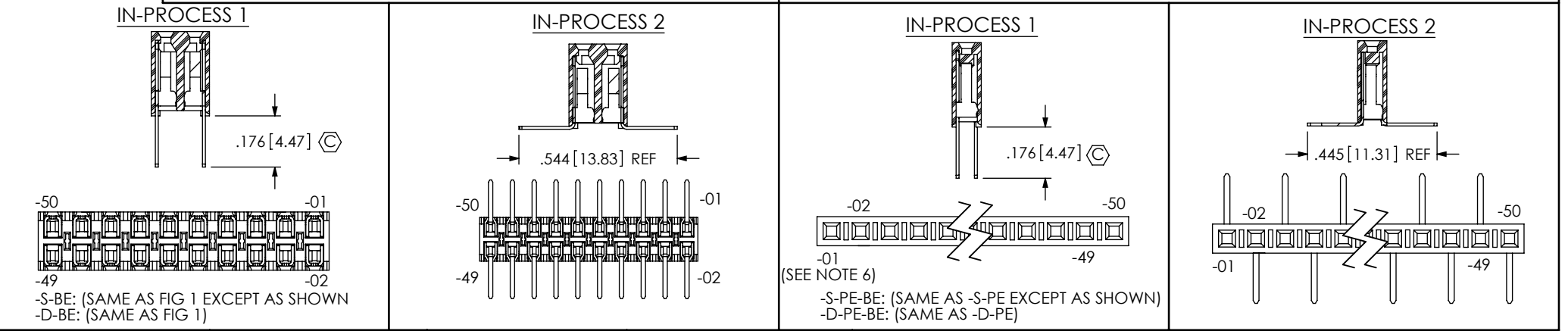

PART NUMBER	TUBE	PLUG
BCS-S-DE	PT-3-24-01-01	TP-03 (2)
BCS-D-DE	PT-1-24-01-15	TP-03 (2)
BCS-S-TE	PT-1-24-01-24	TP-24 (2)
BCS-D-TE	PT-1-24-01-22	TP-03 (2)
BCS-S-HE	PT-1-24-04-38	TP-03 (2)
BCS-D-HE	PT-1-24-03-29	TP-29 (2)
BCS-S-PE	PT-1-24-20-09	TP-09 (2)
BCS-D-PE	PT-1-24-01-15	TP-03 (2)
BCS-S-DE-BE	PT-3-24-01-01	TP-03 (2)
BCS-D-DE-BE	PT-1-24-01-15	TP-03 (2)
BCS-S-PE-BE	PT-1-24-20-09	TP-09 (2)
BCS-D-PE-BE	PT-1-24-01-15	TP-03 (2)

PROPRIETARY NOTE

THIS DOCUMENT CONTAINS INFORMATION
CONFIDENTIAL AND PROPRIETARY TO
SAMTEC, INC. AND SHALL NOT BE REPRODUCED
OR TRANSFERRED TO OTHER DOCUMENTS OR
DISCLOSED TO OTHERS OR USED FOR ANY
PURPOSE OTHER THAN THAT WHICH IT WAS
OBTAINED WITHOUT THE EXPRESSED WRITTEN
CONSENT OF SAMTEC, INC.

DO NOT SCALE DRAWING

SHEET SCALE: 2:1

520 PARK EAST BLVD, NEW ALBANY, IN 47150
PHONE: 812-944-6733 FAX: 812-948-5047
e-Mail info@SAMTEC.com code 55322

DESCRIPTION:
BOX CONNECTOR SOCKET STRIP

DWG. NO.
BCS-1XX-XXX-X-XX-XXX

BY: KOLB 09/12/1991 SHEET 3 OF 3