

NOTES:

- 1.0 MATERIALS:
    - 1.1 HOUSING: STAINLESS STEEL PER ASTM-A582, TYPE 303.
    - 1.2 CENTER CONTACT: BERYLLIUM COPPER ROD ALLOY C172, PER ASTM-B194.
    - 1.3 DIELECTRIC: PTFE FLUOROCARBON PER ASTM-D1457.
  - 2.0 PLATING:
    - 2.1 HOUSING, LOCK NUT AND LOCKWASHER PASSIVATED PER QQ-P-35 AND MILL-F-14072
    - 2.2 CENTER CONTACT: GOLD PER MIL-G-45204 TYPE II, CLASS 1.
  - 3.0 MECHANICAL:
    - 3.1 INTERFACE PER MIL-STD-348 IN ACCORDANCE WITH MIL-A-55339
    - 3.2 CENTER CONTACT CAPTURED IN ACCORDANCE WITH MIL-A-55339
  - 4.0 ELECTRICAL:
    - 4.1 FREQUENCY RANGE: DC to 18.0 GHz
    - 4.2 VSWR: 1.20:1 MAX.
    - 4.3 IPEDENCE: 50 OHMS
  - 5.0 DIMENSIONS IN PARENTHESIS ARE MILLIMETERS.
- ALL OTHER MECHANICAL, ELECTRICAL, AND ENVIRONMENTAL CHARACTERISTICS ARE IN ACCORDANCE WITH MIL-A-55339

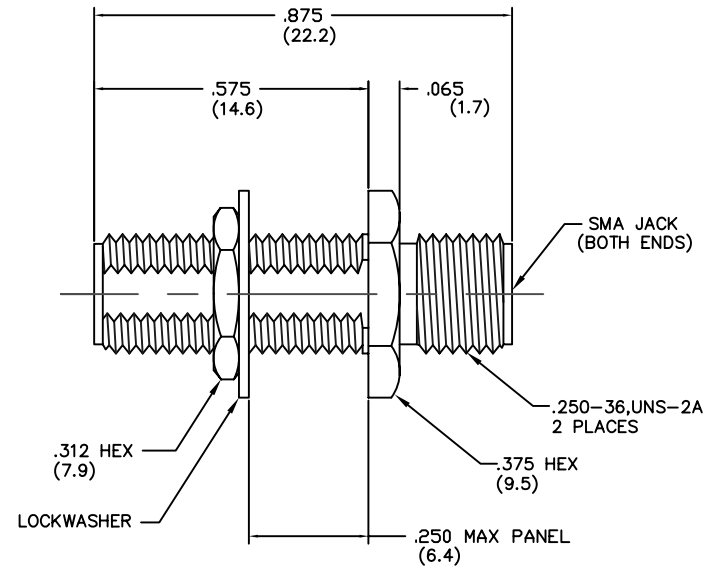
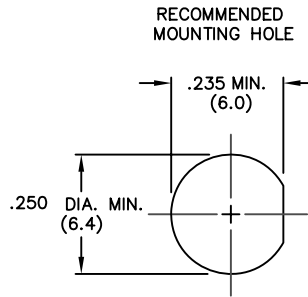

MODEL NUMBER  
ADT-2823-FF-SMA-02

REV.	DESCRIPTION	DATE
-	RELEASED	9/18/92
A	ECN 18845	11/26/02

NOTICE: The information contained in this drawing is proprietary and must not be used without the permission of Emerson Network Power.  UNLESS OTHERWISE NOTED DIMENSIONS ARE IN INCHES AND TOLERANCES ARE: 3 PLACE DECIMALS ±.005 2 PLACE DECIMALS ±.02 FRACTIONS ±1/64 PARALLELITY: T.I.R. _____ FLATNESS: T.I.R. _____ CONCENTRICITY: T.I.R. _____ ANGLES AND PERPENDICULARITY: ±1°	CAGE CODE <b>34078</b>	<b>MIDWEST MICROWAVE</b>	
	EMERSON Network Power Connectivity Solutions	TITLE SMA JACK TO JACK ADT OUTLINE DRAWING	
DRAWN/DATE M.HOLLMAN 9/16/92	ENG./DATE A.OSGA 9/17/92	DRAWING NUMBER ADT-2823-FF-SMA-02-01	REV. A
CHECKED/DATE A.BEATTY 9/16/92	APPROVED/DATE G.HOUGHTON 11/26/02	SCALE: 5=1	SHEET 1 of 1

# Mouser Electronics

Authorized Distributor

Click to View Pricing, Inventory, Delivery & Lifecycle Information:

[Cinch Connectivity Solutions:](#)

[ADT-2823-FF-SMA-02](#)